

GENERAL DESCRIPTION

5' Protector Classmate Laboratory Hood  
Model: 160504102

- Left / Right Facia:  
\* Powder Coated Steel \* Color: Glacier White  
Liner Material:  
\* Tempered Safety Glass  
Side Panels:  
\* Both Sides \* Removable \* Color: Glacier White  
Baffles:  
\* Clear Tempered Safety Glass  
\* Can be tilted for cleaning  
Interior Cover Plates:  
\* Right and Left Lower Sides  
\* 12 Gauge Cold Rolled Steel  
Corner Post with Access Covers:  
\* Right and Left Sides  
\* 18 Gauge Cold Rolled Steel  
Air Foil:  
\* Cold Rolled Steel \* Powder Coat Finish  
Sash:  
\* Vertical Travel  
\* Tempered Safety Glass  
\* Counter Weighted and Balanced  
\* Chain and Sprocket Sash System  
\* Sash Stop at 18"
- Electrical Fixtures:  
\* LED Light with Switch Installed at Factory  
\* Duplex, 115VAC / 60Hz / 20A/ GFCI  
Alarm / Monitor:  
\* None Provided  
Wiring:  
\* Fume Hood Wired at Factory  
\* Electrical Connection made inside 4x7 Junction Box  
\* 100-115V, 50/60 Hz

VAV Preparations

- \* None Provided  
Service Fixtures:  
\* Labconco \* Color-Coded Hooded Handle \* Front Loading  
\* Parts included to convert standard fixtures to Vac or Air

Symbol	Service	Color
CW	Cold Water	Green
Gas	Gas	Blue
Air	Compressed Air	Orange
Vac	Vacuum	Yellow

- Plumbing:  
\* Connections Made with Swagelok Compression Fittings  
\* Final connection by others  
\* Pre-Piped to Valve Outlet  
\* Standard Water Piping is 1/4" Copper Tubing  
\* Air and Vac Piping is 1/4" Copper Tubing  
\* Standard Gas Piping is 1/4" Brass Tubing

Work Surface (Sold Separately)  
\* Black Epoxy Work Surface, Model 96005-XX (See below for XX)

- \* No cup sink # 00  
\* Cup Sink Right Rear # 01  
\* Cup Sink Right Side # 02  
\* Cup Sink Left Rear # 10  
\* Cup Sink Left Side # 20  
\* Cup Sink Left and Right Rear # 11  
\* Cup Sink Left and Right Side # 22  
Cup Sink (Sold Separately)  
\* 4003200  
Required Accessories (Sold Separately)  
\* Remote Blower  
\* Supporting Base

- Assembly and Coating  
\* Pre-Assembled  
\* Painted



FUME HOODS for:

No. \_\_\_\_\_ Date \_\_\_\_\_

\_\_\_\_\_  
\_\_\_\_\_  
\_\_\_\_\_  
\_\_\_\_\_  
\_\_\_\_\_

Date: \_\_\_\_\_

Drawing #  
160504102

Drawn By: \_\_\_\_\_

Checked By: \_\_\_\_\_

Approved By: \_\_\_\_\_

Sheet No. \_\_\_\_\_

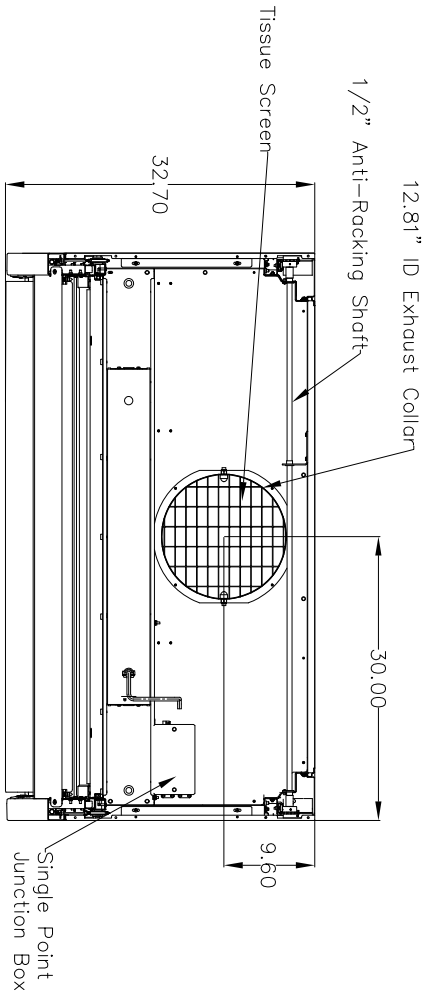

Top View

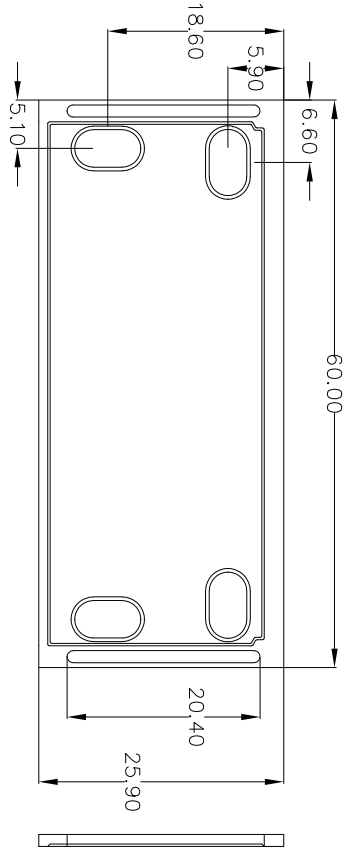

Work Surface: #96005-XX (See General Description for XX value)

Model number varies based on sink location selection

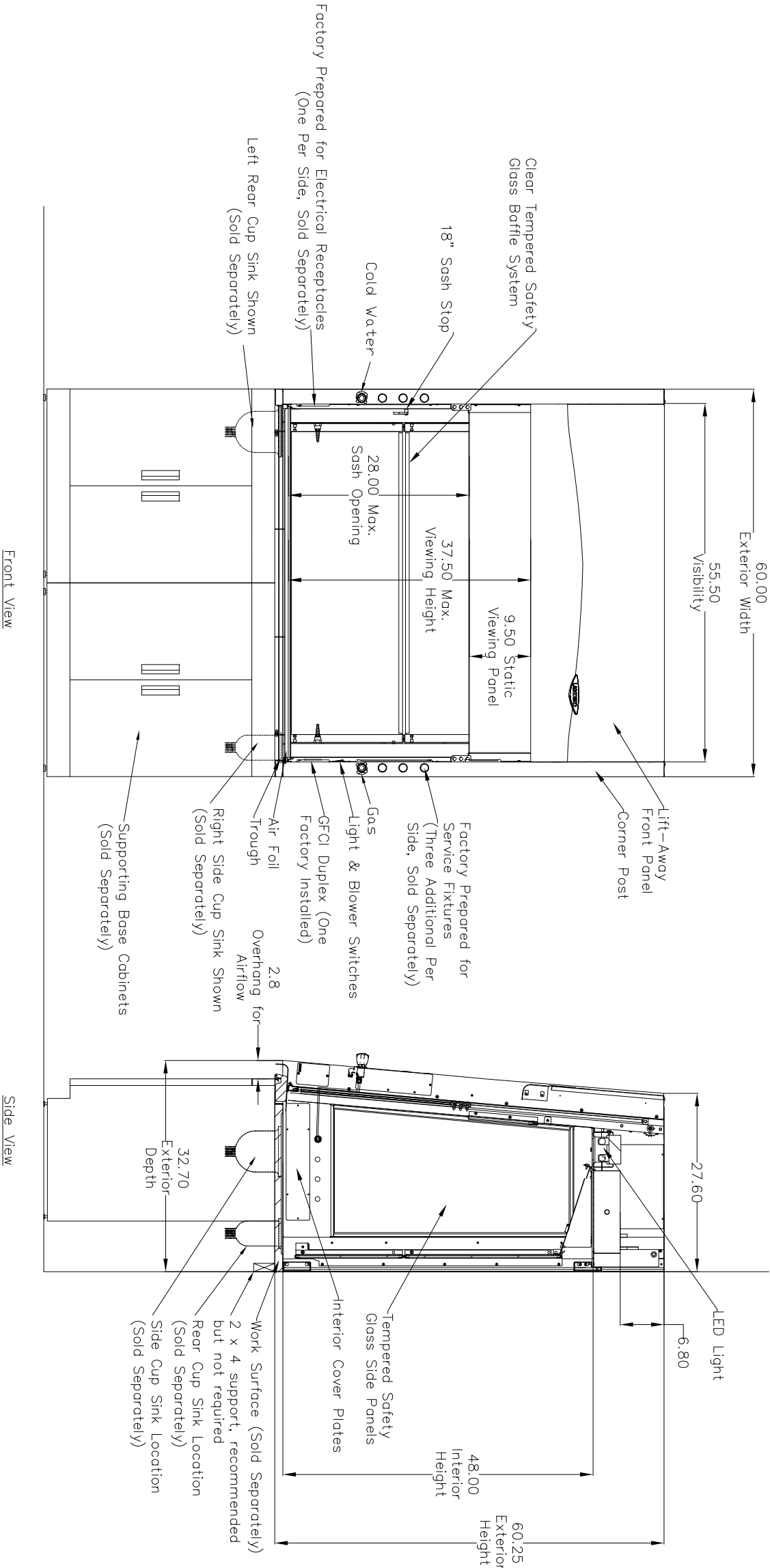

Front View

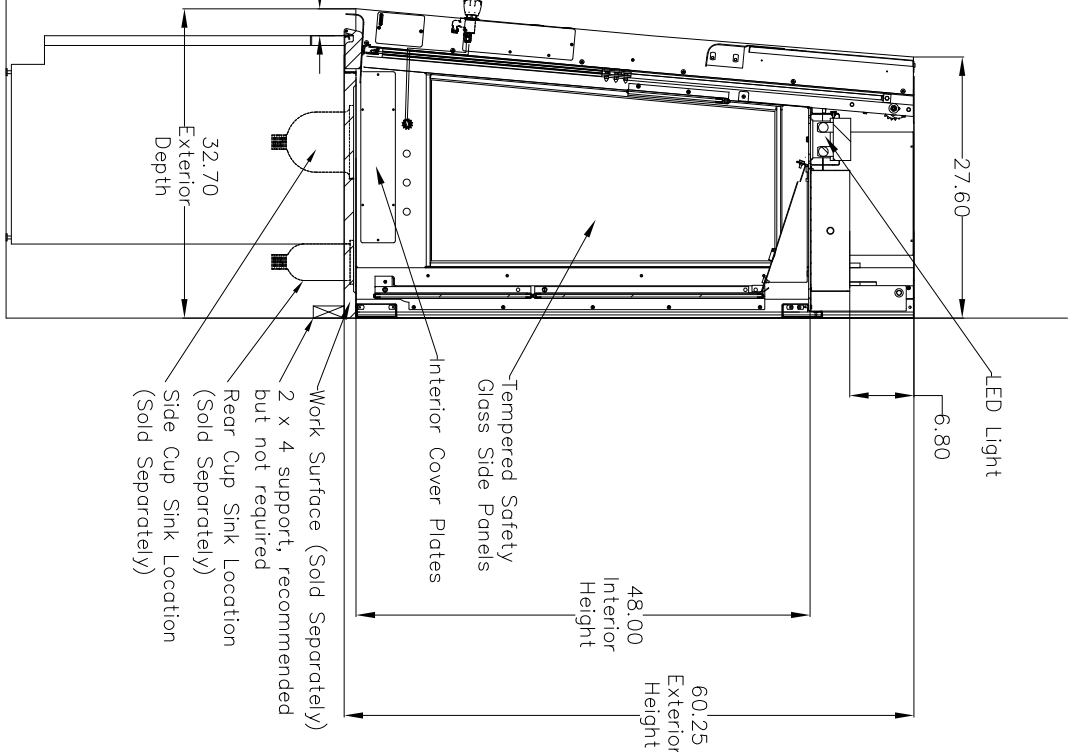

Side View

SCALE: Scaled to fit