

Ductless Chemical Enclosures





Table of Contents

Introduction	3	Protector® XVS Ventilation Stations	
Ductless Carbon Filtered Enclosures		Features & Benefits	16
Selection Guide	4	Performance Features	17
Overview	6	Ordering Information & Dimensional Data	18
Paramount® Ductless Enclosures		Protector Work Stations	
Features & Benefits	7	Features & Benefits	19
Ordering Information & Dimensional Data	9	Ordering Information & Dimensional Data	20
Safety-First Vapor Sensor Details	11	Protector Demonstration Hoods	
Filters & Accessories	12	Features & Benefits	22
Fume Adsorbers		Ordering Information & Dimensional Data	23
Performance Features	14	FilterMate™ Portable Exhausters	
Ordering Information	15	Performance Features	24
		Ordering Information & Dimensional Data	25
		Filters & Accessories	26
		Standards & Registered Trademarks	30

LABCONCO®

The Labconco difference.

Flexible. We make filtered enclosures in a multitude of sizes to fit any need. No ductwork connections means these enclosures can go just about anywhere, giving customers safety where they need it.

Sustainable. Ventilated enclosures can be large consumers of energy for any lab. With filtered enclosures, all of the energy associated with exhausting valuable air, is conserved. Now, even air-starved labs have a containment solution.

Safe. Labconco's filtered enclosures are tested in accordance with industry containment standards to ensure users are provided a safe product. This means customers no longer need to sacrifice peace-of-mind when exploring energy reduction for their labs.

Safety, performance, and comfort you can rely on.
That's the Labconco difference.

Labconco Fume Hoods & Enclosures

Steps to Selecting a Fume Hood

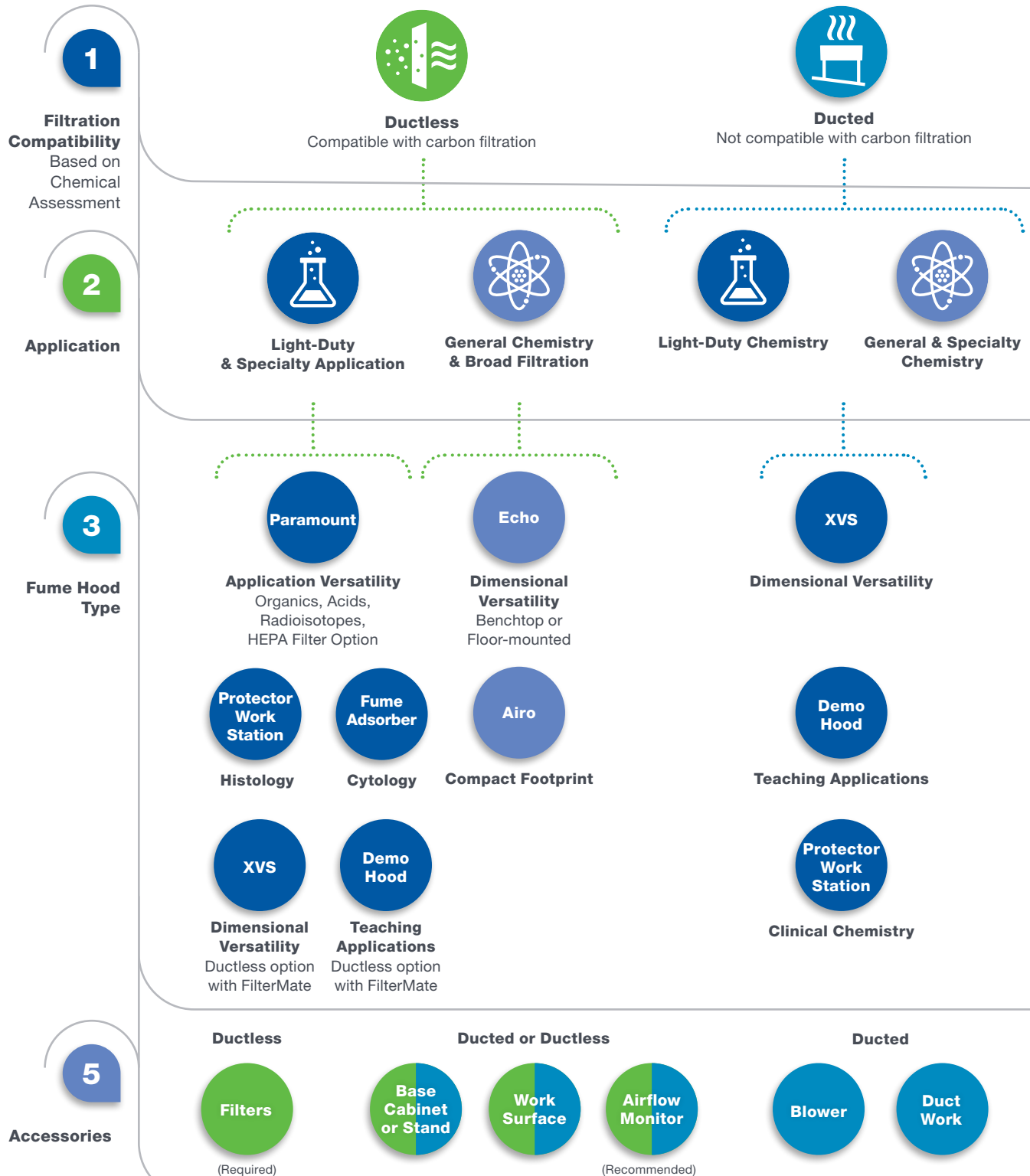

Labconco Fume Hoods & Enclosures

Labconco Product Lines

Ductless Enclosures



Paramount
DH II with Carbon Filter



FilterMate with Enclosure
DH I with Carbon Filter



Protector Work Station
DH I with Carbon Filter



Fume Adsorber
DH I with Carbon Filter



Ductless Fume Hoods



Echo
DH III with Neutrodine Unisorb Filter



Airo
DH III with Neutrodine Unisorb Filter



Accessories



Filters



Base Cabinet or Stand

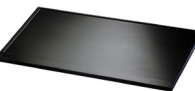

Work Surface



Airflow Monitor



Blower

Ductless Chemical Enclosures

Overview

Determining if a ductless, carbon-filtered enclosure is the right product for your application requires careful consideration. The table below provides examples of appropriate applications for specific filter types in Labconco enclosures. Depending on the enclosure, several filter types may be used.

- **Acid-Sulfur Carbon Filters** for acid and sulfur gases
- **Ammonia Carbon Filters** for ammonia and low amines
- **Formaldehyde Carbon Filters** for vapors from formaldehyde
- **Mixed Bed Carbon Filters** are a combination of Organic, Acid-Sulfur, Formaldehyde and Ammonia media
- **Organic Carbon Filters** for vapors from solvents
- **Radioisotope Carbon Filters** for iodine radioisotope vapors

- **HEPA Filters**, 99.99+% efficient (0.3 microns), are suitable for removing non-biohazardous particulates and powders

Ductless Hood Services

To determine if your application is suitable for a ductless enclosure, Labconco offers an exclusive **Chemical Assessment** available at labconco.com. After submitting your assessment form, a Labconco specialist analyzes your chemical application and provides you with a report recommending the appropriate enclosure.

The **Filter Reminder Service** alerts you with an email when it is time to check or change your filters.

The online **Chemical Guide** provides a reference to check a specific chemical's suitability for a ductless enclosure.



Access services at
labconco.com/services

Application Matrix by Filter Type

	HEPA	Radioisotope	Organic	Ammonia	Formaldehyde	HEPA + Carbon	Mixed Bed	Acid-Sulfur
Acid pouring and mixing							•	•
Cleanroom/critical environment						•		
Combination dry and liquid chemicals						•		
Endoscopy instrument cleaning					•			
Fertilizer research				•				
Histology/cytology tissue staining, coverslipping			•				•	
Iodine isotope handling		•						
Non-biohazardous microbiological samples with trace chemicals*						•		
Particulates in conjunction with chemical agents						•		
Pathology/tissue grossing							•	
Pollen handling	•							
Science education							•	
Soldering			•			•		
Solvent cleaning, welding/gluing			•				•	

*Ductless carbon-filtered enclosures are not designed to accommodate changing and disposal of biohazardous filters and materials and, therefore, should not be used as biosafety enclosures.

Paramount® Ductless Enclosures

Features & Benefits



❖ **Safety-First Vapor Sensor** accurately detects filter break through. The sensor also provides an early warning when 5-10% of filter life is remaining to allow time for the user to change filters. See page 11 for details.

LCD screen displays face velocity and filter status, and offers touchpad control of enclosure.

Upper dilution air supply sweeps clean air to the back of the sash to keep contaminants away from the operator.

Upper containment sash foil directs contaminants away from the user's breathing zone.

Aerodynamically designed corner posts reduce turbulence and enhance containment.

❖ **Patented* Clean-Sweep™ air foil** allows air to sweep the work surface to maximize containment.

Quieter, cooler and more energy-efficient ECM impeller

❖ **Durable powder-coated aluminum frame, steel rear baffle and plenum** provide chemical resistance and robust construction. No unreliable plastic-to-plastic bonding is used.

❖ **Smart-Flow™ System** adjusts the motor speed automatically to maintain constant airflow.

❖ **Patented* rear baffle** promotes non-turbulent horizontal laminar airflow. The baffle pivots down for cleaning.

Optional clear safety glass baffle provides 360° visibility for teaching demonstrations.

Two utility ports allow passage of tubing, electrical cords and interface cables from inside to back exterior for connection to services.

Ergonomic angled sash and patented sloped front** allows for a closer view of the work area, and provides a more comfortable operating position when sitting.

Hinged sash pivots upward for loading and has a wiping seal to contain contaminants. Larger models incorporate an external gas-assist lift.

Spacious sash opening provides comfortable access to the work area.



Convenient, front-accessible filter replacement. opens effortlessly for leak-proof, one-step filter replacement.

❖ Labconco exclusive feature

*U.S. Patent No. 6,461,233

**U.S. Patent No. 538,941



Paramount® Ductless Enclosures

Performance Features



All models feature:

- * Clean-Sweep™ air foil*
- * Upper dilution air supply
- * Upper containment sash foil
- Zone-perforated rear baffle that pivots down for cleaning
- Safety-First™ vapor sensor with early audible warning for accurate detection of filter break through
- * ECM impeller with timer that operates at 52-62 dBA at 80 feet per minute. 6' Paramounts have two impellers
- * Smart-Flow™ system to automatically adjust motor speed
- * LCD message center, 3" x 1.5", to provide continuous status reports for each filter, airflow speed, filter saturation, and low airflow alarm messages
- Filter life and filter check time alarms, with audible and visual indicators including time elapsed



Filter types, status, and estimated filter life for all filters can be indicators.

- Digital touchpad controls
- * Powder-coated aluminum frame and steel rear plenum and baffle
- Pre-wired fluorescent lamp with timer
- Password-protected electronic security lock
- 1/4" thick tempered safety glass front sash and sides.
- Ergonomic angled and hinged pivoting sash with wiping seal and patented** sloped front
- * Filter efficiency performance independently verified by University of Kansas
- Particulate containment data independently confirmed by SafeBridge[†] Consultants, Inc.
- 8.2' power cord and plug. No plug on 230 volt models.
- ETL[†] listed (115 volt models)

All models conform to the following regulations and standards[†]:

- SEFA 9, DH II
- SEFA 8
- ASHRAE 110
- ANSI Z9.5
- UL 61010
- CAN/CSA C22.2 No. 61010
- CE/UKCA Conformity Marking (230 volt models)

Models with glass baffle feature:

- 1/4" thick tempered safety glass baffle without perforations that pivots down for cleaning

All models require (not included):

- Work Surface and Base. See pages 12 & 13. Contact Labconco for stand and cabinet options
- Filters. See page 12

Optional accessories:

- Canopy Exhaust Transition. See page 13
- Sash Closures. See page 13
- Utility Shelves, Bottle Holder and Tissue Holder. See page 27

[†]See page 30 for a list of regulations, standards and registered trademarks.

*U.S. Patent No. 6,461,233

**U.S. Patent No. 5,38,941

* Labconco exclusive feature



Paramount® Ductless Enclosures

Ordering Information & Dimensional Data

Nominal Width	Catalog Number (Description)	Electrical Requirements	Overall Dimensions (w x d x h)	Internal Working Height	Sash Opening Working Height	Sash Opening Loading Height	Face Velocity (fpm)	Airflow Exhaust Volume (CFM)	Shipping Weight
2'	6963200	115V, 50/60 Hz	24.0" x 29.0" x 43.7" (61.0 x 73.7 x 111.0 cm)	22.7" (57.7 cm)	9.4" (23.9 cm)	19.0" (48.3 cm)	60, 80, 100	85, 115, 145	175 lbs. (79 kg)
2'	6963220*	230V, 50/60 Hz	24.0" x 29.0" x 43.7" (61.0 x 73.7 x 111.0 cm)	22.7" (57.7 cm)	9.4" (23.9 cm)	19.0" (48.3 cm)	60, 80, 100	85, 115, 145	175 lbs. (79 kg)
3'	6963300	115V, 50/60 Hz	36.0" x 29.0" x 43.7" (91.4 x 73.7 x 111.0 cm)	22.7" (57.7 cm)	9.4" (23.9 cm)	19.0" (48.3 cm)	60, 80, 100	130, 175, 220	225 lbs. (102 kg)
3'	6963301 (Tall)	115V, 50/60 Hz	36.0" x 29.0" x 53.0" (91.4 x 73.7 x 134.6 cm)	32.0" (81.3 cm)	12.0" (30.5 cm)	28.3" (71.8 cm)	60, 80, 100	170, 230, 285	255 lbs. (116 kg)
3'	6963302† (Tall & Clear)	115V, 50/60 Hz	36.0" x 29.0" x 53.0" (91.4 x 73.7 x 134.6 cm)	32.0" (81.3 cm)	12.0" (30.5 cm)	28.3" (71.8 cm)	60, 80, 100	170, 230, 285	275 lbs. (125 kg)
3'	6963320*	230V, 50/60 Hz	36.0" x 29.0" x 43.7" (91.4 x 73.7 x 111.0 cm)	22.7" (57.7 cm)	9.4" (23.9 cm)	19.0" (48.3 cm)	60, 80, 100	130, 175, 220	225 lbs. (102 kg)
3'	6963321* (Tall)	230V, 50/60 Hz	36.0" x 29.0" x 53.0" (91.4 x 73.7 x 134.6 cm)	32.0" (81.3 cm)	12.0" (30.5 cm)	28.3" (71.8 cm)	60, 80, 100	170, 230, 285	255 lbs. (116 kg)
3'	6963322*† (Tall & Clear)	230V, 50/60 Hz	36.0" x 29.0" x 53.0" (91.4 x 73.7 x 134.6 cm)	32.0" (81.3 cm)	12.0" (30.5 cm)	28.3" (71.8 cm)	60, 80, 100	170, 230, 285	275 lbs. (125 kg)
4'	6963400	115V, 50/60 Hz	48.0" x 29.0" x 43.7" (121.9 x 73.7 x 111.0 cm)	22.7" (57.7 cm)	9.4" (23.9 cm)	19.0" (48.3 cm)	60, 80, 100	175, 235, 295	275 lbs. (125 kg)
4'	6963401 (Tall)	115V, 50/60 Hz	48.0" x 29.0" x 53.0" (121.9 x 73.7 x 134.6 cm)	32.0" (81.3 cm)	12.0" (30.5 cm)	28.3" (71.8 cm)	60, 80, 100	230, 305, 380	315 lbs. (143 kg)
4'	6963402† (Tall & Clear)	115V, 50/60 Hz	48.0" x 29.0" x 53.0" (121.9 x 73.7 x 134.6 cm)	32.0" (81.3 cm)	12.0" (30.5 cm)	28.3" (71.8 cm)	60, 80, 100	230, 305, 380	345 lbs. (156 kg)
4'	6963403 (Tall & Deep)	115V, 50/60 Hz	48.0" x 35.5" x 56.0" (121.9 x 90.2 x 142.2 cm)	35.0" (88.9 cm)	12.0" (30.5 cm)	31.3" (79.4 cm)	60, 80, 100	230, 305, 380	540 lbs. (245 kg)
4'	6963420*	230V, 50/60 Hz	48.0" x 29.0" x 43.7" (121.9 x 73.7 x 111.0 cm)	22.7" (57.7 cm)	9.4" (23.9 cm)	19.0" (48.3 cm)	60, 80, 100	230, 305, 380	275 lbs. (125 kg)
4'	6963421* (Tall)	230V, 50/60 Hz	48.0" x 29.0" x 53.0" (121.9 x 73.7 x 134.6 cm)	32.0" (81.3 cm)	12.0" (30.5 cm)	28.3" (71.8 cm)	60, 80, 100	175, 235, 295	315 lbs. (143 kg)
4'	6963422*† (Tall & Clear)	230V, 50/60 Hz	48.0" x 29.0" x 53.0" (121.9 x 73.7 x 134.6 cm)	32.0" (81.3 cm)	12.0" (30.5 cm)	28.3" (71.8 cm)	60, 80, 100	230, 305, 380	345 lbs. (156 kg)
4'	6963423* (Tall & Deep)	230V, 50/60 Hz	48.0" x 35.5" x 56.0" (121.9 x 90.2 x 142.2 cm)	35.0" (88.9 cm)	12.0" (30.5 cm)	31.3" (79.4 cm)	60, 80, 100	230, 305, 380	540 lbs. (245 kg)
5'	6963501 (Tall)	115V, 50/60 Hz	60.0" x 29.0" x 53.0" (152.4 x 73.7 x 134.6 cm)	32.0" (81.3 cm)	9.4" (23.9 cm)	28.3" (71.8 cm)	60, 80, 100	220, 295, 370	395 lbs. (179 kg)
5'	6963503 (Tall & Deep)	115V, 50/60 Hz	60.0" x 35.5" x 56.0" (152.4 x 90.2 x 142.2 cm)	35.0" (88.9 cm)	9.4" (23.9 cm)	31.3" (79.4 cm)	60, 80, 100	220, 295, 370	565 lbs. (256 kg)
5'	6963521* (Tall)	230V, 50/60 Hz	60.0" x 29.0" x 53.0" (152.4 x 73.7 x 134.6 cm)	32.0" (81.3 cm)	9.4" (23.9 cm)	28.3" (71.8 cm)	60, 80, 100	220, 295, 370	395 lbs. (179 kg)
5'	6963523* (Tall & Deep)	230V, 50/60 Hz	60.0" x 35.5" x 56.0" (152.4 x 90.2 x 142.2 cm)	35.0" (88.9 cm)	9.4" (23.9 cm)	31.3" (79.4 cm)	60, 80, 100	220, 295, 370	565 lbs. (256 kg)
6'	6963601 (Tall)	115V, 50/60 Hz	72.0" x 29.0" x 53.0" (182.9 x 73.7 x 134.6 cm)	32.0" (81.3 cm)	12.0" (30.5 cm)	28.3" (71.8 cm)	60, 80, 100	350, 465, 580	475 lbs. (215 kg)
6'	6963603 (Tall & Deep)	115V, 50/60 Hz	72.0" x 35.5" x 56.0" (182.9 x 90.2 x 142.2 cm)	35.0" (88.9 cm)	12.0" (30.5 cm)	31.3" (79.4 cm)	60, 80, 100	350, 465, 580	680 lbs. (308 kg)
6'	6963621* (Tall)	230V, 50/60 Hz	72.0" x 29.0" x 53.0" (182.9 x 73.7 x 134.6 cm)	32.0" (81.3 cm)	12.0" (30.5 cm)	28.3" (71.8 cm)	60, 80, 100	350, 465, 580	475 lbs. (215 kg)
6'	6963623* (Tall & Deep)	230V, 50/60 Hz	72.0" x 35.5" x 56.0" (182.9 x 90.2 x 142.2 cm)	35.0" (88.9 cm)	12.0" (30.5 cm)	31.3" (79.4 cm)	60, 80, 100	350, 465, 580	680 lbs. (308 kg)

*International electrical configuration

†360° visibility with glass rear wall and baffle

Paramount® Ductless Enclosures

Ordering Information & Dimensional Data

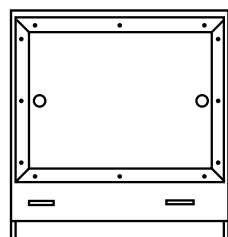

TOP

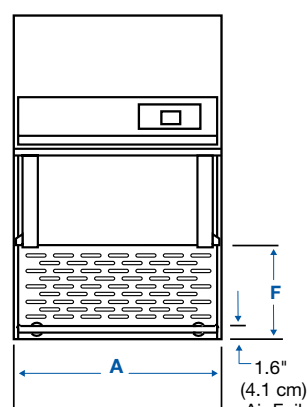

FRONT

Catalog Numbers	Paramount Description	Exterior Width A	Interior Height B	Interior Depth C	Enclosure Depth D	Enclosure Height E	Sash Height F
6963200 6963220	2' Standard	24.0" (61.0 cm)	22.7" (57.7 cm)	23.4" (59.4 cm)	29.0" (73.7 cm)	43.7" (111.0 cm)	9.4" (23.9 cm)
6963300 6963320	3' Standard	36.0" (91.4 cm)	22.7" (57.7 cm)	23.4" (59.4 cm)	29.0" (73.7 cm)	43.7" (111.0 cm)	9.4" (23.9 cm)
6963301 6963321	3' Tall	36.0" (91.4 cm)	32.0" (81.3 cm)	23.4" (59.4 cm)	29.0" (73.7 cm)	53.0" (134.6 cm)	12.0" (30.5 cm)
6963302 6963322	3' Tall with Clear Baffle	36.0" (91.4 cm)	32.0" (81.3 cm)	23.4" (59.4 cm)	29.0" (73.7 cm)	53.0" (134.6 cm)	12.0" (30.5 cm)
6963400 6963420	4' Standard	48.0" (121.9 cm)	22.7" (57.7 cm)	23.4" (59.4 cm)	29.0" (73.7 cm)	43.7" (111.0 cm)	9.4" (23.9 cm)
6963401 6963421	4' Tall	48.0" (121.9 cm)	32.0" (81.3 cm)	23.4" (59.4 cm)	29.0" (73.7 cm)	53.0" (134.6 cm)	12.0" (30.5 cm)
6963402 6963422	4' Tall with Clear Baffle	48.0" (121.9 cm)	32.0" (81.3 cm)	23.4" (59.4 cm)	29.0" (73.7 cm)	53.0" (134.6 cm)	12.0" (30.5 cm)
6963403 6963423	4' Tall & Deep	48.0" (121.9 cm)	35.0" (88.9 cm)	30.0" (76.2 cm)	35.5" (90.2 cm)	56.0" (142.2 cm)	12.0" (30.5 cm)
6963501 6963521	5' Tall	60.0" (152.4 cm)	32.0" (81.3 cm)	23.4" (59.4 cm)	29.0" (73.7 cm)	53.0" (134.6 cm)	9.4" (23.9 cm)
6963503 6963523	5' Tall & Deep	60.0" (152.4 cm)	35.0" (88.9 cm)	30.0" (76.2 cm)	35.5" (90.2 cm)	56.0" (142.2 cm)	9.4" (23.9 cm)
6963601 6963621	6' Tall	72.0" (182.9 cm)	32.0" (81.3 cm)	23.4" (59.4 cm)	29.0" (73.7 cm)	53.0" (134.6 cm)	12.0" (30.5 cm)
6963603 6963623	6' Tall & Deep	72.0" (182.9 cm)	35.0" (88.9 cm)	30.0" (76.2 cm)	35.5" (90.2 cm)	56.0" (142.2 cm)	12.0" (30.5 cm)

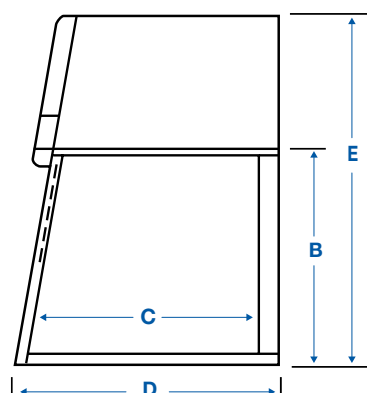

SIDE (Standard models)

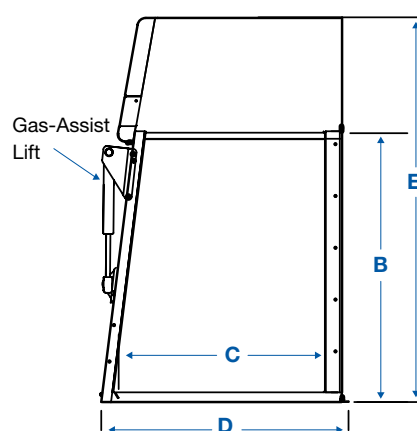

SIDE (Tall models)

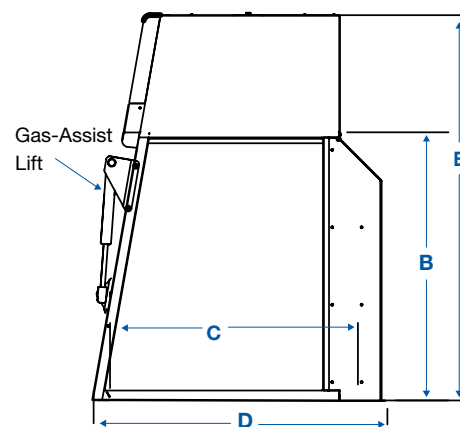

SIDE (Tall and Deep models)

Paramount® Ductless Enclosures

Safety-First™ Vapor Sensor Details

Chemical Sensitivity Alert Concentrations

Typical chemicals detected by the Safety First Organic Vapor Sensor are indicated in the chart below.

Chemical Family	Chemical	Sensitivity Alert Concentration	Odor Threshold (ppm)	Exposure Limit TWA* (ppm)	Filter Capacity† (% W)	Filter Type
Aldehydes & Ketones	Cyclohexanone	0.2-0.5 ppm	0.068	50	22%	OV
Mixture of Aliphatic Hydrocarbons	Gasoline	0.3-1.0 ppm	0.3	300	11%	OV
Particulates	Cigarette smoke	0.4-1.0 ppm	N/A	N/A	N/A	OV & HEPA
Aldehydes & Ketones	Acetone	0.5-1.0 ppm	4.58	250	2%	OV
Aromatic Hydrocarbons	Toluene	0.5-1.0 ppm	0.16	100	20%	OV
Ethers	Methyl Tert-Butyl Ether	0.5-1.0 ppm	0.053	50	9%	OV
Sulfur Compounds	Hydrogen Sulfide	0.5-2.0 ppm	0.0005	10	10%	AG
Nitrogen Compounds	Diethylamine	1.5-2.0 ppm	0.186	10	7%	OV
Esters	Ethyl Acetate	1.5-4 ppm	0.61	400	9%	OV
Esters	Diethyl Ether	2-4 ppm	2.29	400	4%	OV
Aldehydes	Formaldehyde	4 ppm, best to use other detector methods	0.87	0.1 ceiling, 0.016	10%	FORM
Nitrogen Compounds	Ammonia Solution (Ammonium Hydroxide)	2-5 ppm	5.75	25	10%	AM
Alcohols	Ethyl Alcohol**	2.5-6 ppm	0.136	1000	1.3%	OV
Acids	Acetic Acid	5-6 ppm	0.016	10	4%	OV
Halogens	Chlorobenzene	5-8 ppm	0.741	10	20%	OV
Alcohols	Isopropyl Alcohol	8-11 ppm	22	200	7%	OV
Aliphatic Hydrocarbons	Hexane	9-15 ppm	21.9	50	11%	OV
Alcohols	Methanol**	15-25 ppm	141	200	0.1%, very low	Not Recommended
Mineral Acids	Hydrochloric Acid	Not detected.† † Use other means.	0.77	5	17%	AG

*Time-weighted average recommended by NIOSH †Based on 10 ppm inlet concentration

**Important Note: Clean up procedures using alcohols or volatile chemicals with low filter capacity could saturate the filters quickly.

††Important Note: The vapor sensor does not detect mineral acid gases such as hydrochloric acid, nitric acid, or sulfuric acid.

OV=Organic Vapors, AG=Acid-Sulfur Gases, FORM=Formaldehyde, AM=Ammonia-Amine

Paramount® Ductless Enclosures

Filters & Accessories



Black Solid Epoxy Work Surfaces. Chemical-resistant, solid epoxy work surfaces are dished to contain spills and contoured to fit the dimensions of Paramount Ductless Enclosures. 1.0" (2.5 cm) thick.

Catalog Number	Nominal Width	For use with	Dimensions (w x d)	Shipping Weight
3909900	2'	Paramount	24.0" x 29.0" (61.0 x 73.7 cm)	50 lbs. (23 kg)
3909901	3'	Paramount	36.0" x 29.0" (91.4 x 73.7 cm)	75 lbs. (34 kg)
3909902	4'	Paramount	48.0" x 29.0" (121.9 x 73.7 cm)	100 lbs. (45 kg)
3909906	4'	Paramount, Deep	48.0" x 35.5" (121.9 x 90.2 cm)	125 lbs. (56 kg)
3909907	5'	Paramount	60.0" x 29.0" (152.4 x 73.7 cm)	125 lbs. (56 kg)
3909908	5'	Paramount, Deep	60.0" x 35.5" (152.4 x 90.2 cm)	155 lbs. (70 kg)
3909910	6'	Paramount	72.0" x 29.0" (182.9 x 73.7 cm)	150 lbs. (68 kg)
3909911	6'	Paramount, Deep	72.0" x 35.5" (182.0 x 90.2 cm)	186 lbs. (84 kg)



Stainless Steel Work Surfaces. Type 304 stainless steel work surfaces include a 0.8" (2.0 cm) deep front trough to contain spills. 0.8" (2.0 cm) thick.

Catalog Number	Nominal Width	For use with	Dimensions (w x d)	Shipping Weight
3975504	4'	Paramount, Deep	48.0" x 35.5" (121.9 x 90.2 cm)	145 lbs. (65 kg)
3975502	5'	Paramount	60.0" x 29.0" (152.4 x 73.7 cm)	150 lbs. (68 kg)
3975503	5'	Paramount, Deep	60.0" x 35.5" (152.4 x 90.2 cm)	180 lbs. (82 kg)
3975602	6'	Paramount	72.0" x 29.0" (182.9 x 73.7 cm)	180 lbs. (82 kg)
3975603	6'	Paramount, Deep	72.0" x 35.5" (182.0 x 90.2 cm)	220 lbs. (100 kg)

Paramount Filters

Contain porous, coconut shell carbon for maximum adsorption. Roughing prefilters are adhered to both sides of each filter to remove dust and other particles. All impregnated carbon filters contain 25% activated carbon by weight.

Paramount Width	Number of Filters Required (not included)	Typical Net Filter Weight
2'	2	15 lbs. (6.8 kg)
3'	4	30 lbs. (13.6 kg)
4'	6	45 lbs. (20.4 kg)
5'	6	45 lbs. (20.4 kg)
6'	8	60 lbs. (27.2 kg)

Catalog Number	Filter Description	Shipping Weight
6938100	HEPA, 99.99% efficient particulate	15 lbs. (6.8 kg)
6938200	Activated Carbon, Organic Vapor, 7.5 lbs.	30 lbs. (13.6 kg)
6938201	Impregnated Carbon, Acid-Sulfur, 10 lbs.	45 lbs. (20.4 kg)
6938202	Impregnated Carbon, Ammonia-Amine, 11 lbs.	45 lbs. (20.4 kg)
6938203	Impregnated Carbon, Formaldehyde, 10 lbs.	60 lbs. (27.2 kg)
6938204	Mixed Bed Carbon, 10 lbs. Contains approximately 43% Activated Carbon (Organic Vapor), 19% Acid-Sulfur, 19% Ammonia Amine and 19% Formaldehyde by weight	15.0 lbs. (6.8 kg)
6938205	Impregnated Carbon, Radioisotope, 10 lbs.	15.0 lbs. (6.8 kg)

Filter Accessories

Catalog Number	Description	Shipping Weight
6924900	Syringe Kit for carbon filter saturation detection	15 lbs. (6.8 kg)
6925700	Ammonia Detector Tubes, package of 3	30 lbs. (13.6 kg)
6925800	Acid Gas Detector Tubes, package of 3	45 lbs. (20.4 kg)
6926000	Formaldehyde Detector Tubes, package of 3	45 lbs. (20.4 kg)

Detector tubes required for chemicals not detected by the Organic Vapor Sensor

Paramount® Ductless Enclosures

Filters & Accessories



SoLo™ Hydraulic Lift Base Stands. Allow Paramounts to transport through standard doorways. Powder-coated steel. Remote-control operated hydraulic lift provides infinitely adjustable work surface heights from 15.2" to 34.8" high. Depth is 34.3". Toe-locking casters, 5" diameter, with bearings. Work surface is required.

Catalog Number	Nominal Width	Actual Width	Electrical Requirements	Shipping Weight
3780310	3'	53.5" (135.9 cm)	115V, 60 Hz, 2 amps	395 lbs. (179 kg)
3780314*	3'	53.5" (135.9 cm)	230V, 50 Hz, 3 amps	395 lbs. (179 kg)
3780311	4'	65.5" (166.4 cm)	115V, 60 Hz, 2 amps	435 lbs. (197 kg)
3780315*	4'	65.5" (166.4 cm)	230V, 50 Hz, 3 amps	435 lbs. (197 kg)
3780312	5'	77.5" (196.9 cm)	115V, 60 Hz, 2 amps	460 lbs. (209 kg)
3780316*	5'	77.5" (196.9 cm)	230V, 50 Hz, 3 amps	460 lbs. (209 kg)
3780313	6'	89.5" (227.3 cm)	115V, 60 Hz, 2 amps	600 lbs. (272 kg)
3780317*	6'	89.5" (227.3 cm)	230V, 50 Hz, 3 amps	600 lbs. (272 kg)



6963700—Canopy Exhaust Transition. Allows the Paramount Ductless Enclosure to be thimble-ducted to the outside for additional protection. The canopy's air gap provides a means of balancing air by allowing

room air to enter the duct work and mix with the filtered air being exhausted from the Paramount. House exhaust or remote blower and ductwork are required (not included). 6" (15 cm) diameter outlet. 6' Paramount Enclosures require two Exhaust Transitions. **Requires installation.** Contact Labconco for ordering information on remote blowers and ductwork. Shipping weight 18 lbs. (8 kg)

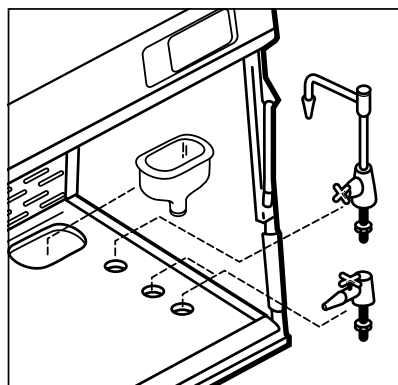

Epoxy Work Surface with Deck-Mounted Service Fixtures.

Pre-drilled holes allow installation of two deck-mounted service fixtures with hose barbs for plumbing to water, air and vacuum; a 3" x 6" cupsink; and a gooseneck faucet with vacuum breaker. Two standard chrome-plated service fixtures with

turrets, hose barbs, brass valves and 3/8" NPS pipe connections; a 3" x 6" polypropylene oval cupsink; and a brass cold water faucet with swivel/ rigid gooseneck, brass valve and 1/4" NPS pipe connection are included. 29.0" (73.7 cm) x 1.0" (2.5 cm) thick.

Catalog Number	Nominal Width	For use with	Dimensions (w x d)	Shipping Weight
6963800	3'	Paramount	36.0" (91.4 cm)	85 lbs. (38 kg)
6963801	4'	Paramount	48.0" (121.9 cm)	110 lbs. (50 kg)
6963802	5'	Paramount	60.0" (152.4 cm)	135 lbs. (61 kg)
6963803	6'	Paramount	72.0" (182.9 cm)	160 lbs. (72 kg)



Sash Closures. Bi-fold doors close the sash opening to prevent contaminants from entering the enclosure during periods of non-use. Include powder-coated steel doors and mounting hardware. **Requires installation.**

Catalog Number	Sash Closure Dimensions (w x h)	Shipping Weight
6963900	24.0" x 9.4" (61.0 x 23.9 cm)	10 lbs. (5 kg)
6963901	36.0" x 9.4" (91.4 x 23.9 cm)	12 lbs. (6 kg)
6963902	36.0" x 12.0" (91.4 x 30.5 cm)	15 lbs. (7 kg)
6963903	48.0" x 9.4" (121.9 x 23.9 cm)	16 lbs. (7 kg)
6963904	48.0" x 12.0" (121.9 x 30.5 cm)	20 lbs. (9 kg)
6963905	60.0" x 9.4" (152.4 x 23.9 cm)	25 lbs. (12 kg)
6963906	72.0" x 12.0" (182.9 x 30.5 cm)	30 lbs. (14 kg)

*International electrical configuration

Fume Adsorbers

Performance Features



Left: Fume Adsorber 3955200 is shown with Flat Solid Epoxy Work Surface 4882803 and Protector Solvent Storage Cabinet 9902000. Right: Fume Adsorber-2 3955400 is shown with Flat Solid Epoxy Work Surface 4882804 and Protector Standard Storage Cabinets 9904500 and 9904200. Work surfaces and base cabinets must be ordered separately.

Fume Adsorbers are designed for light duty applications involving organic solvents, formaldehyde, ammonia or low molecular weight amines. Fume Adsorbers use carbon filtration to trap vapors so that safe, filtered air is returned to the laboratory. No outside ducting is required. These portable, low profile enclosures fit easily on counter-tops with overhanging cabinets and are available in two widths.

Each Fume Adsorber includes one carbon filter (each Fume Adsorber-2 includes two) that adsorbs vapors from organic solvents, formaldehyde or ammonia, depending on the filter.

All models feature:

- Built-in motorized impellers to provide face velocity up to 35 fpm
- Powder-coated steel housing with perforated baffle for uniform airflow
- Clear, one-piece, 3/8" thick, shatter-resistant acrylic canopy
- Quiet operation at 58-63 dBA
- Rear-mounted auxiliary electrical receptacle and top-mounted blower switch with circuit breaker
- Rear-mounted air sampling port
- Exterior dimensions: 15.4" h x 23.4" d
- Interior dimensions: 13.5" h x 14.5" d
- Available in two widths: 30.0" and 60.0"

All models conform to the following regulations and standards:

- SEFA 9, DH I
- SEFA 8
- UL 61010-1 (115 volt models)
- CAN/CSA C22.2 No. 61010-1 (115 volt models)
- CE/UKCA Conformity Marking (230 volt models)

Fume Adsorber Model 3955200 features one each and Fume Adsorber-2 Model 3955400 features two each:

- Replaceable 6 pound Type AC activated carbon filter, 26.0" w x 9.0" h, to adsorb organic vapors such as xylene and toluene. Adsorbs up to one third its weight

Fume Adsorber Model 3955201 features one each and Fume Adsorber-2 Model 3955401 features two each:

- Replaceable 7.5 pound impregnated carbon filter, 26.0" w x 9.0" h, treated to adsorb formaldehyde. Adsorption weight 10% (0.75 lb.)

Fume Adsorber Model 3955202 features one each and Fume Adsorber-2 Model 3955402 features two each:

- Replaceable 8.8 pound impregnated carbon filter, 26.0" w x 9.0" h, treated to adsorb ammonia and low molecular weight amine vapors. Adsorption weight 10% (0.88 lb.)

Fume Adsorber Models 3955200, 3955201 and 3955202 and Fume Adsorber-2 Models 3955400, 3955401 and 3955402 feature:

- Operation on 115 volts, 60 Hz, 2 amps
- 6.5' IEC three-wire cord with plug

Fume Adsorber Models 3955220, 3955221 and 3955222 and Fume Adsorber-2 Models 3955420, 3955421 and 3955422 feature:

- Operation on 230 volts, 50 Hz, 1 amp
- 9' IEC three-wire cord. An electrical plug is required

If not placed on existing casework, all models require:

- Flat Work Surface. Contact Labconco
- Base Stand or Cabinet. Contact Labconco

*See page 26 for a list of regulations, standards and registered trademarks.



Fume Adsorbers

Ordering Information

Catalog Number	Description	Shipping Weight
3955200	Fume Adsorber with Activated Carbon Filter for Organic Vapors. 30.0" exterior width, 29.25" interior width, for 115 volt, 60 Hz, 2 amp operation.	67 lbs. (30 kg)
3955201	Fume Adsorber with Impregnated Carbon Filter for Formaldehyde Vapors. 30.0" exterior width, 29.25" interior width, for 115 volt, 60 Hz, 2 amp operation.	67 lbs. (30 kg)
3955202	Fume Adsorber with Impregnated Carbon Filter for Ammonia Vapors. 30.0" exterior width, 29.25" interior width, for 115 volt, 60 Hz, 2 amp operation.	67 lbs. (30 kg)
3955220*	Fume Adsorber with Activated Carbon Filter for Organic Vapors. 30.0" exterior width, 29.25" interior width, for 230 volt, 50 Hz, 1 amp operation.	67 lbs. (30 kg)
3955221*	Fume Adsorber with Impregnated Carbon Filter for Formaldehyde Vapors. 30.0" exterior width, 29.25" interior width, for 230 volt, 50 Hz, 1 amp operation.	67 lbs. (30 kg)
3955222*	Fume Adsorber with Impregnated Carbon Filter for Ammonia Vapors. 30.0" exterior width, 29.25" interior width, for 230 volt, 50 Hz, 1 amp operation.	67 lbs. (30 kg)
3955400	Fume Adsorber-2 with Activated Carbon Filters for Organic Vapors. 60.0" exterior width, 59.25" interior width, for 115 volt, 60 Hz, 2 amp operation.	135 lbs. (61 kg)
3955401	Fume Adsorber-2 with Impregnated Carbon Filters for Formaldehyde Vapors. 60.0" exterior width, 59.25" interior width, for 115 volt, 60 Hz, 2 amp operation.	137 lbs. (62 kg)
3955402	Fume Adsorber-2 with Impregnated Carbon Filters for Ammonia Vapors. 60.0" exterior width, 59.25" interior width, for 115 volt, 60 Hz, 2 amp operation.	139 lbs. (63 kg)
3955420*	Fume Adsorber-2 with Activated Carbon Filters for Organic Vapors. 60.0" exterior width, 59.25" interior width, for 230 volt, 50 Hz, 2 amp operation.	135 lbs. (61 kg)
3955421*	Fume Adsorber-2 with Impregnated Carbon Filters for Formaldehyde Vapors. 60.0" exterior width, 59.25" interior width, for 230 volt, 50 Hz, 2 amp operation.	137 lbs. (62 kg)
3955422*	Fume Adsorber-2 with Impregnated Carbon Filters for Ammonia Vapors. 60.0" exterior width, 59.25" interior width, for 230 volt, 50 Hz, 2 amp operation.	139 lbs. (63 kg)

Catalog Number	Description	Shipping Weight
6961300	Replacement Activated Carbon Filter for use with organic vapors. 6 pounds of activated carbon. Adsorbs up to one third of its weight. Adsorption capacity dependent on chemical properties.** One each. Fume Adsorber Models 3955200 and 3955220 require one filter; Fume Adsorber-2 Models 3955400 and 3955420 require two filters.	9 lbs. (4 kg)
6961301	Replacement Formaldehyde Carbon Filter for use with formaldehyde and gluteraldehyde. 7.5 pounds of impregnated carbon. Adsorption weight 10% (0.75 lb.). Adsorption volume 850 ml of 37% formalin. One each. Fume Adsorber Models 3955201 and 3955221 require one filter; Fume Adsorber-2 Models 3955401 and 3955421 require two filters.	11 lbs. (5 kg)
6961302	Replacement Ammonia Carbon Filter for use with ammonia and low molecular weight amines. 8.8 pounds of impregnated carbon. Adsorption weight 10% (0.88 lbs.). Adsorption volume 800 ml of 50% ammonia. One each. Fume Adsorber Models 3955202 and 3955222 require one filter; Fume Adsorber-2 Models 3955402 and 3955422 require two filters.	13 lbs. (6 kg)
6924900	Syringe Kit for carbon saturation detection. Contaminant detector tubes are not included (See Detector Tubes below or contact your safety supply distributor).	1 lb. (0.5 kg)
6926000	Formaldehyde Detector Tubes, package of 3.	0.5 lb. (0.2 kg)
6925700	Ammonia Detector Tubes, package of 3.	0.5 lb. (0.2 kg)

*International electrical configuration

**Complete the Chemical Assessment Form at labconco.com/services

Protector® XVS Ventilation Stations

Features & Benefits



❖ **Tempered safety glass front sash, sides and top** offers excellent visibility, ambient light and protection. Glass provides better fire, scratch and chemical resistance than acrylic and dissipates static charge.

Aerodynamically designed corner posts reduce turbulence and enhance containment.

❖ **Sturdy powder-coated aluminum frame and steel rear plenum and baffle** dissipate static charge and provide durability and better chemical resistance compared to acrylic models.

❖ **Patented* Clean-Sweep™ air foil** allows air to sweep the work surface for maximum containment.

Low profile design requires less space than most ventilated enclosures.

❖ **Upper dilution air supply** introduces room air at the top of the sash to dilute contaminants in the upper chamber and bathes the back of the sash with clean air.

Two utility ports allow passage of tubing, electrical cords and interface cables from inside to back exterior for connection to services.

❖ **Patented* rear baffle with zones of perforations** promotes horizontal laminar airflow to maximize containment. The baffle pivots down and is easily removable for cleaning.

Ergonomic angled sash allows a closer view and provides a more comfortable operating position.

Patented* upper containment sash foil bleeds air into the enclosure to direct concentrations of contaminants away from the operator's breathing zone.

Deep interior easily accommodates a variety of apparatus including large balances.

Flexible exhaust options. Rectangular exhaust openings on the top and bottom allow the Protector XVS Ventilation Station to be connected to ductwork or to FilterMate™ Portable Exhauster(s) for filtered removal of fumes, particulates or powders. Using the bottom exhaust opening keeps ductwork hidden, maximizing room visibility.



Left-side mounted waste chute, standard on some 5', 6' and 8' models, isolates contaminated waste in a sealable bag (bags not included).

Protector XVS Ventilation Stations provide an economical alternative to traditional fume hoods and are well suited for classroom and educational laboratory environments where supervision or demonstrations are required. These may also be used as weighing stations, light duty fume hoods, solvent cleaning work bays, and veterinary pathology and cytology enclosures. XVS Stations exhaust less tempered room air and conserve more energy than traditional hoods. They have no switches, wiring or service fixtures that add incremental costs.

Protector XVS Stations may be connected to a remote blower and exhausted to the outside. Alternatively, they may be connected to the FilterMate Portable Exhauster(s), which uses a carbon filter(s), a HEPA filter(s) or HEPA/carbon filter combination to remove fumes and vapors and/or hazardous particulates from the exhaust air without ducting.

❖ Labconco exclusive feature

*U.S. Patent No. 6,461,23

**Contact Labconco for more information

Protector® XVS Ventilation Stations

Performance Features

All models feature:

- Bypass airflow design
- * Deep interior of 23.4" or 30.0" depending on the model
- * Clean-Sweep* air foil
- * Upper dilution air supply
- * Upper containment sash foil
- * Zone-perforated, pivoting rear baffle*
- Side-entry air foils
- Powder-coated aluminum frame and steel rear plenum and baffle
- Clear 1/4" thick tempered safety glass front sash, sides and top.
- * Ergonomic 20° angled and hinged, pivoting sash with wiping seal. Sashes on 5', 6' and 8' models incorporate an external gas-assist lift
- Models with 8.0" sash opening height have 16.5" locking height. Models with 10.0" or 12.0" sash opening height have 25.75" locking height
- Two utility ports with iris openings and plastic plugs
- 2" x 10" rectangular exhaust openings at the top and bottom. 5', 6' and 8' models include three openings on the top and bottom. Cover(s) provided for unused openings
- Particulate containment independently verified by SafeBridge Consultants, Inc.††
- Modified ASHRAE 110 conformity as low as 50 fpm independently verified by ECT, Inc.†††

All models conform to the following regulations and standards†:

- SEFA 9, DH I (when connected to a FilterMate Portable Exhauster)
- SEFA 1 (Ducted models only)
- SEFA 8
- Modified ASHRAE 110
- ANSI Z9.5

5', 6' and 8' models with 35.5" exterior depth include:

- Left-side mounted waste chute. Bags not included. Minimum bag size required: 10" x 16"

All models require:

- Remote blower or FilterMate Portable Exhauster(s) (each sold separately). Contact Labconco for blower information. See pages 26 for FilterMate Ordering Information
- Work surface. See page 26
- Exhaust Transition Adapters. See page 29
- Supporting base. Contact labconco
- Ductwork. See page 29

Optional accessories:

- Guardian™ Airflow Monitors. See page 28
- Fluorescent Task Lights. See page 27
- Utility Shelves, Bottle Holder and Tissue Holder. See page 27
- Waste Chute Stopper. See page 27
- Waste Chute Bags. Contact your laboratory supply dealer

Nominal Width	Height	Sash Opening Ht.	Total Exhaust CFM and Static Pressure (w.g.)		
			100 fpm/S.P.	80 fpm/S.P.	60 fpm/S.P.
2'	Standard	8"	120/0.05"	95/0.03"	70/0.02"
2'	Tall	10"	150/0.08"	120/0.05"	90/0.03"
3'	Standard	8"	185/0.10"	145/0.06"	110/0.04"
3'	Tall	10"	230/0.15"	185/0.10"	140/0.06"
4'	Standard	8"	250/0.16"	200/0.10"	150/0.06"
4'	Tall	10"	310/0.24"	250/0.16"	185/0.09"
5'	Standard	8"	315/0.23"	250/ 0.15"***	190/0.08"
5'	Tall	12"	480/0.54"	385/ 0.35"***	290/0.20"
6'	Standard	8"	380/0.32"	305/ 0.21"***	230/0.12"
6'	Tall	102"	580/0.75"	465/0.48"***	350/0.27"
8'	Standard	8"	510/0.18"	410/ 0.12"††	310/0.07"
8'	Tall	12"	775/0.42"	620/ 0.27"††	465/0.15"

**Static pressure when one center exhaust opening is used.

†See page 30 for a list of regulations, standards and registered trademarks.

††Static pressure when two outer exhaust openings are used. Requires "T" Connector 3981600, not included. Contact Labconco.

†††Exposure Control Technologies, Inc., Cary, NC. Contact Labconco for more information.

* Labconco exclusive feature

*U.S. Patent No. 6,461,233

Protector® XVS Ventilation Stations

Ordering Information & Dimensional Data

Nominal Width	Catalog Number	Overall Height (A) in./cm	Overall Depth (B) in./cm	C in./cm	D in./cm	E in./cm	F in./cm	G in./cm	H in./cm	I in./cm	J in./cm	Shipping Weight
2'	4862010	22.8/57.9	29.0/73.7	24.0/61.0	12.0/30.5	21.6/54.9	22.3/56.6	19.0/48.3	23.4/59.4	8.0/20.3	-	105 lbs. (48 kg)
2'	4862030	32.0/81.3	29.0/73.7	24.0/61.0	12.0/30.5	21.6/54.9	31.5/80.0	27.7/70.4	23.4/59.4	10.0/25.4	-	135 lbs. (61 kg)
3'	4863010	22.8/57.9	29.0/73.7	36.0/91.4	18.0/45.7	33.6/85.3	22.3/56.6	19.0/48.3	23.4/59.4	8.0/20.3	-	135 lbs. (61 kg)
3'	4863030	32.0/81.3	29.0/73.7	36.0/91.4	18.0/45.7	33.6/85.3	31.5/80.0	27.7/70.4	23.4/59.4	10.0/25.4	-	160 lbs. (73 kg)
4'	4864010	22.8/57.9	29.0/73.7	48.0/121.9	24.0/61.0	45.6/115.8	22.3/56.6	19.0/48.3	23.4/59.4	8.0/20.3	-	160 lbs. (73 kg)
4'	4864030	32.0/81.3	29.0/73.7	48.0/121.9	24.0/61.0	45.6/115.8	31.5/80.0	27.7/70.4	23.4/59.4	10.0/25.4	-	185 lbs. (84 kg)
5'	4865010	22.8/57.9	29.0/73.7	60.0/152.4	30.0/76.2	57.6/146.3	22.3/56.6	19.0/48.3	23.4/59.4	8.0/20.3	10.0/25.4	290 lbs. (132 kg)
5'	4865030	32.0/81.3	29.0/73.7	60.0/152.4	30.0/76.2	57.6/146.3	31.5/80.0	27.7/70.4	23.4/59.4	12.0/30.5	10.0/25.4	340 lbs. (154 kg)
5'	4865060	32.0/81.3	35.5/90.2	60.0/152.4	30.0/76.2	57.6/146.3	31.5/80.0	27.7/70.4	30.0/76.2	12.0/30.5	10.0/25.4	380 lbs. (172 kg)
6'	4866010*	22.8/57.9	29.0/73.7	72.0/182.9	36.0/91.4	69.6/176.8	22.3/56.6	19.0/48.3	23.4/59.4	8.0/20.3	10.0/25.4	340 lbs. (154 kg)
6'	4866030	32.0/81.3	29.0/73.7	72.0/182.9	36.0/91.4	69.6/176.8	31.5/80.0	27.7/70.4	23.4/59.4	12.0/30.5	10.0/25.4	395 lbs. (179 kg)
6'	4866060*	32.0/81.3	35.5/90.2	72.0/182.9	36.0/91.4	69.6/176.8	31.5/80.0	27.7/70.4	30.0/76.2	12.0/30.5	10.0/25.4	440 lbs. (220 kg)
8'	4868010	22.8/57.9	29.0/73.7	96.0/243.8	48.0/121.9	93.6/237.7	22.3/56.6	19.0/48.3	23.4/59.4	8.0/20.3	24.0/61.0	455 lbs. (206 kg)
8'	4868030	32.0/81.3	29.0/73.7	96.0/243.8	48.0/121.9	93.6/237.7	31.5/80.0	27.7/70.4	23.4/59.4	12.0/30.5	24.0/61.0	520 lbs. (236 kg)
8'	4868060*	32.0/81.3	35.5/90.2	96.0/243.8	48.0/121.9	93.6/237.7	31.5/80.0	27.7/70.4	30.0/76.2	12.0/30.5	24.0/61.0	580 lbs. (263 kg)

Note: Optional Airflow Monitor adds 5.8" to overall height.

*Includes waste chute

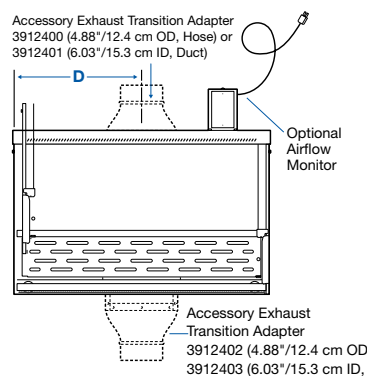

FRONT (2', 3', 4' Models)

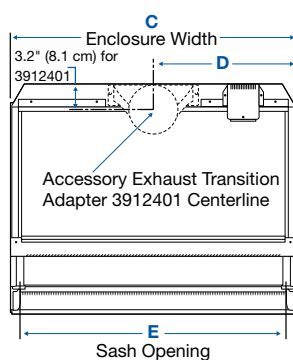

TOP (2', 3', 4' Models)

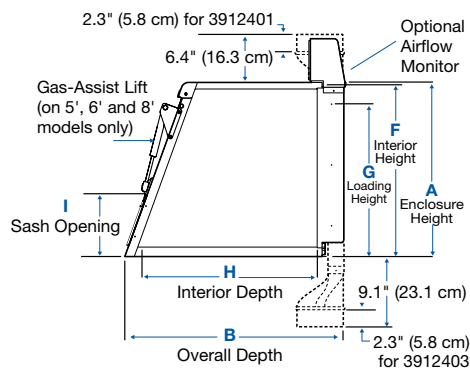

SIDE (All Models)

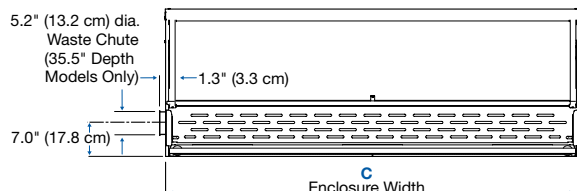

FRONT (5', 6', 8' Models)

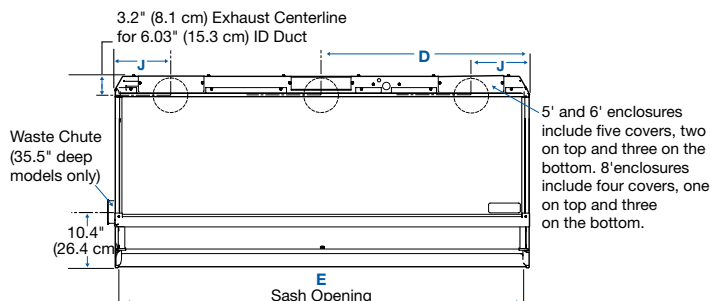

TOP (5', 6', 8' Models)

Contact Labconco at (800) 821-5525 or (816) 333-8811 or visit labconco.com for detailed AutoCAD® drawings.

*See page 30 for a list of regulations, standards and registered trademarks.

Protector® Work Stations

Features and Benefits

- * **Patented* Type 304 stainless steel rear baffle with zones of perforations**

Two convenient utility ports with iris openings (Models 3930001 and 3930021 only) allow passage of tubing and electrical cords from equipment inside the enclosure through the back for connection to services. Plugs are provided to seal the ports when not in use.

Side-entry air enhance containment of hazardous materials within the Workstation.

- * **Clean-Sweep™ air foil*** sweeps air over the work surface for maximum and comfortable supports a user's arms.

Glare-free fluorescent lighting brightly illuminates the work surface.



Flexible exhaust options (Models 3930001 and 3930021 only). 2" x 10" rectangular exhaust openings on the top and bottom allow for exhausting to the outside.

Flexible exhaust options (Models 3930001 and 3930021 only). 2" x 10" rectangular exhaust openings on the top and bottom allow for exhausting to the outside.

Ergonomic 8" sash opening is sloped to provide enhanced comfort and containment.

Optional Guardian™ 1000 Digital or Guardian™ 500 Airflow Monitor alerts the user to face velocities outside of pre-set range.

- * **Patented* upper containment sash foil** bleeds air into the enclosure to direct contaminants away from the operator's breathing zone.

- * **Upper dilution air supply** introduces room air at the top of the sash to dilute contaminants in the upper chamber and bathes the back of the sash with clean air.

Sturdy and chemical-resistant construction. Powder-coated metal construction and high visibility protective tempered safety glass provide durability and safety.

Integrated blower maintains safe airflow and quiet operation.

Performance tested to modified ASHRAE 110



- * **Optional Epoxy Work Surfaces** with or without sink.

Protector Work Stations are specifically designed for the needs of pathologists and histotechnologists. These enclosures rely on patented* containment-enhancing features to rid the laboratory of solvent vapors associated with gross sectioning, trimming, coverslipping and staining.

Protector Work Stations are available in two configurations. Models designed for connection to a remote blower or house exhaust system offer protection from a broad range of chemicals and are recommended when chemical concentrations are high, unknown or unpredictable. In lieu of outside ducting, these models

may also be connected to the FilterMate™ Portable Exhauster, which returns filtered air to the laboratory. The FilterMate Portable Exhauster and filters are sold separately.**

Alternatively, if ducting to the outside is not feasible, Protector Work Stations with a built-in blower are available. These enclosures accommodate two large carbon filters—Organic, Formaldehyde or Ammonia—used in any combination. The filters keep low concentrations of these chemicals below OSHA-recommended time-weighted average (TWA) levels, restoring clean air to the laboratory. Carbon Filters are sold separately.

**See pages 20-21 for ordering information on FilterMate Portable Exhausters
See page 23 for ordering information on Work Surface 6942003.

* Labconco exclusive feature

*U.S. Patent No. 6,461,233



Protector® Work Stations

Ordering Information & Dimensional Data



Shown with optional sink-integrated work surface.

All models feature:

- * Clean-Sweep™ air foil
- * Upper dilution air supply
- * Upper containment sash foil*
- * Zone-perforated Type 304 stainless steel rear baffle that pivots down and is removable for cleaning*
- Side-entry air foils
- Powder-coated aluminum frame and steel rear plenum
- 1/4" thick tempered safety glass front sash and sides
- 8" high sash opening
- Ergonomic 20° angled and hinged sash with wiping seals and springloaded latch that pivots upward and locks to a 19.0" height
- Fluorescent lighting
- Light and blower switches
- Exterior rear-mounted electrical receptacle

All models conform to the following regulations and standards†:

- SEFA 9, DH I (Built-in blower models or models connected to FilterMate Portable Exhauster only)
- SEFA 1 (Ducted models only)
- SEFA 8
- Modified ASHRAE 110
- ANSI‡ Z9.5
- UL 61010-1 (115 volt models)
- CAN/CSA C22.2‡ No. 61010-1 (115 volt models)
- CE/UKCA Conformity marking (230 volts models)

Models 3930000 and 3930020 are designed for use with two carbon filters (not included) and feature:

- Built-in dynamically-balanced motorized impeller
- Speed control
- Baffle with two release knobs that pivots down for filter access
- Quiet operation. See chart below

Models 3930000 and 3930020 require (not included):

- Two Carbon Filters. See page 26

Models 3930001 and 3930021 are designed for use with remote blower or FilterMate Portable Exhauster and feature:

- 2" x 10" rectangular exhaust openings on the top and bottom.
- Two utility ports with iris openings and plugs
- Static pressure loss from 0.06" to 0.16". See chart below

Models 3930001 and 3930021 require (not included):

- Remote blower, house exhaust or FilterMate™ Portable Exhauster. Contact Labconco for Remote Blower. See pages 24 for FilterMate
- Exhaust Transition Adapters. See page 25
- Ductwork. Contact Labconco

All models require (not included):

- Supporting work surface. See page 26-27
- Supporting base. Contact Labconco

Optional accessories include:

- Guardian™ Airflow Monitors. See page 28
- Utility Shelves, Bottle Holder and Tissue Holder. See page 27
- Remote Blowers. See page 29 or contact Labconco

Face Velocity (fpm)	Exhaust Volume (CFM)	Noise Pressure db(A) (Models 3930000 & 3930020)	Static Pressure Loss (Inches of H2O) (Models 3930001 & 3930021)
60	150	57-59	0.06"
80	200	62-64	0.10"
100	250	69-71	0.16"

* Labconco exclusive feature

† See page 30 for a list of regulations, standards and registered trademarks.

* U.S. Patent No. 6,461,233



Protector® Work Stations

Ordering Information & Dimensional Data

3.2" (8.1 cm) Centerline of optional transition adapter 3912401

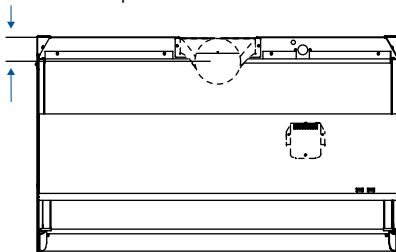

TOP
(Models
3930001 &
3930021)

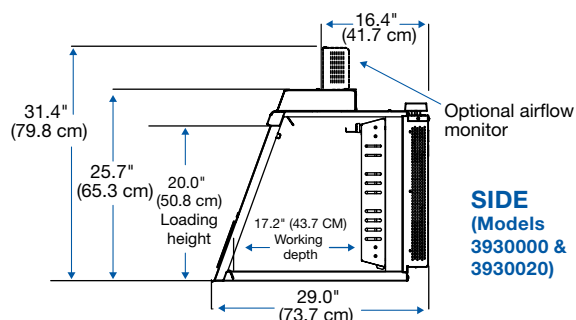

SIDE
(Models
3930000 &
3930020)

Optional airflow monitor

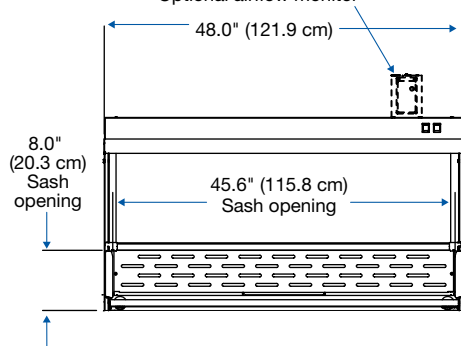

FRONT
(All models)

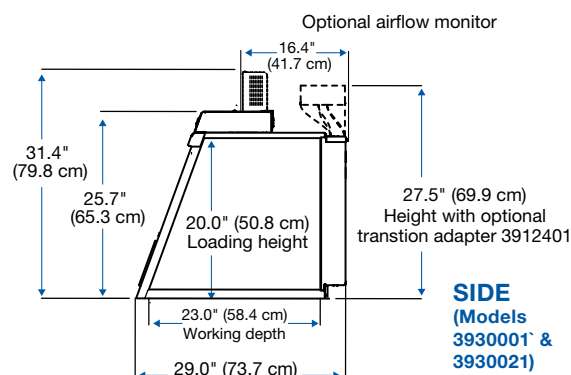

SIDE
(Models
3930001 &
3930021)

Catalog Number	Electrical Requirements	Power Cord & Plug	Blower	Carbon Filters	Shipping Weight
3930000	115V, 60 Hz, 10 amps	6.5'	Built-in	Requires two	120 lbs. (54 kg)
3930001	115V, 60 Hz, 10 amps	6.5'	Requires remote blower, house exhaust or FilterMate Portable Exhauster*		100 lbs. (45 kg)
3930020	230V, 50/60 Hz, 5 amps	9'. No Plug.	Built-in	Requires two	120 lbs. (54 kg)
3930021	230V, 50/60 Hz, 5 amps	9'. No Plug.	Requires remote blower, house exhaust or FilterMate Portable Exhauster*		100 lbs. (45 kg)

**See page 25 for ordering information on Remote Blowers and pages 20-21 for ordering information on FilterMate Portable Exhausters.



Carbon Filters and Accessories for use with Protector Work Stations

Protector Work Stations 3930000 or 3930020 require two each Carbon Filters, either two of the same filter or a combination of two filters.

Catalog Number	Description	Shipping Weight
3924200	Organic Carbon Filter, Type RL10. Contains 11 pounds of granular activated carbon media	12 lbs. (5.4 kg)
3924201	Formaldehyde Carbon Filter. Contains a minimum of 13 pounds of impregnated carbon media	14 lbs. (6.4 kg)
3924202	Ammonia Carbon Filter. Contains a minimum of 15 pounds of impregnated carbon media	16 lbs. (7.3 kg)
6925700	Ammonia Detector Tubes, package of 3	0.5 lb. (0.2 kg)
6926000	Formaldehyde Detector Tubes, package of 3	0.5 lb. (0.2 kg)
6924900	Syringe Kit for carbon filter saturation detection	1 lb. (0.5 kg)

Labconco strongly recommends ordering and keeping an extra set of filters to have readily available when filters become saturated and require replacement.

Protector® Demonstration Hoods

Features & Benefits



Protector Demonstration Hoods are low profile, light-duty fume hoods designed to provide 360° of close observation of procedures during educational demonstrations.

All models feature:

- * Deep 23" interior that easily accommodates a variety of apparatus
- * Patented* Clean-Sweep™ air foil that allows air to sweep the work surface for maximum containment
- Upper containment sash foil that bleeds air into the enclosure to direct concentrations of contaminants away from the operator's breathing zone
- * Upper dilution air supply that introduces room air at the top of the sash to dilute concentrations in the upper chamber and bathes the back of the sash with clean air
- * Clear rear baffle that directs air streams to the back of the interior for removal through the exhaust connection. The baffle may be pivoted downward for cleaning. Side-entry air foils
- Aerodynamically designed corner posts reduce turbulence and enhance containment
- Powder-coated aluminum frame
- Tempered safety glass front sash, sides, rear baffle and top that offer excellent visibility, ambient light and protection. Glass provides better fire, scratch and corrosion resistance than acrylic
- 8" high sash opening limits exhaust demand, and conserves costly tempered room air
- * Ergonomic angled sash allows a closer view, and provides a more comfortable operating position Models, 22.8" high, have a 20° angle; models, 32.0" high, have a 14° angle
- Lower exhaust tissue screen
- Two utility ports with iris openings that allow passage of tubing, electrical cords and interface cables from inside to back exterior for connection to services

- Rectangular exhaust collars (2" x 10") on the top and bottom allow the Protector Demonstration Hood to be connected to ductwork or to a FilterMate™ Portable Exhauster. Using the bottom exhaust collar keeps ductwork hidden, maximizing room visibility

All models conform to the following regulations and standards†:

- SEFA 9, DH I (when connected to a FilterMate Portable Exhauster)
- SEFA 8
- SEFA 1 (Ducted models only)
- Modified ASHRAE 110
- ANSI Z9.5
- UL 61010-1 (115 volt models)
- CAN/CSA C22.2 No. 61010-1 (115 volt models)
- CE/UKCA Conformity Marking (230 volt models)

System Models 3945000, 3945001, 3945020 & 3545021 also feature:

- Powder coated tubular steel cart with black 1" thick solid epoxy dished work surface, handle bar, bottom shelf and 4" diameter toe-locking casters
- FilterMate Portable Exhauster designed for use with two Carbon Filters or one Carbon Filter and one HEPA Filter (filters are not included). See FilterMate Portable Exhauster details on page 26
- ETL listed (115 volt models)

Models 3944300 & 3944301 require:

- Connection to a remote blower, house exhaust or FilterMate Portable Exhauster. See pages 24 for FilterMate. See page 29 for Remote Blowers and Ductwork
- Work surface and supporting base. See page 27 for cart. See page 26 for work surface. Contact Labconco for base stands and cabinets
- Exhaust Transition Adapters. See page 29

Accessories include:

- Fluorescent Task Lights. See page 27
- Guardian™ Airflow Monitors. See page 28
- Remote Blowers and duct accessories. See page 29 or contact Labconco

Nominal Width	Overall Height	Sash Overall Height	Total Exhaust CFM and Static Pressure					
			100 fpm	S.P.	80 fpm	S.P.	60 fpm	S.P.
3'	22.8"	8"	185	0.10"	145	0.06"	110	0.04"
3'	32.0"	10"	230**	0.15"	185	0.10"	140	0.06"

**FilterMate Portable Exhauster with two filters provides up to 220 CFM and with single filter provides up to 270 CFM.

* Labconco exclusive feature

*U.S. Patent No. 6,461,233

†See page 30 for a list of regulations, standards and registered trademarks.



Protector® Demonstration Hoods

Ordering Information & Dimensional Data

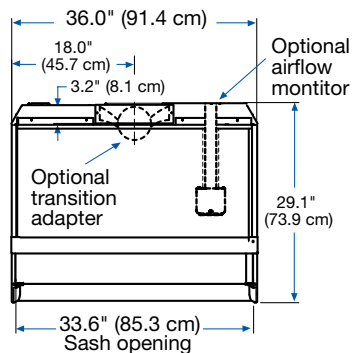

TOP
(3944300, 3944301)

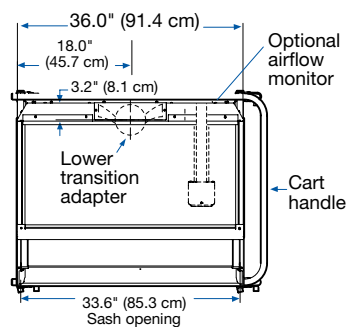

TOP
(3945000, 3945001,
3945020 & 3945021)

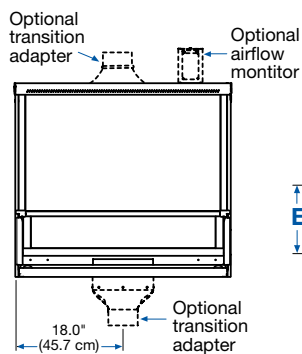

FRONT
(3944300, 3944301)

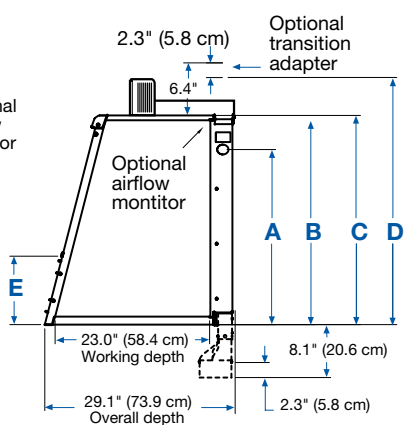

SIDE
(3944300, 3944301)

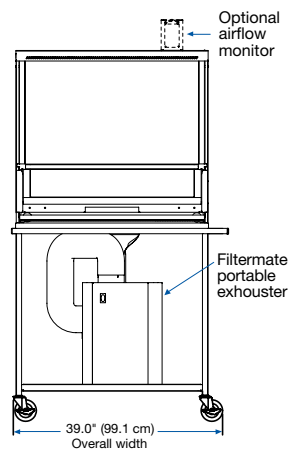

FRONT
(394500, 3945001,
3945020 & 3945021)

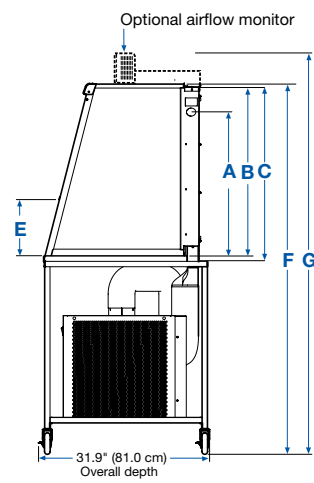

SIDE
(3945000, 3945001,
3945020 & 3945021)

	A Loading height	B Interior height	C Enclosure height	D Height with monitor	E Sash opening	F Height with cart	G Height with cart and monitor
3944300 3945000 3945020	19.0" (48.3 cm)	22.3" (56.4 cm)	22.8" (57.9 cm)	22.8" (57.9 cm)	8.0" (20.3 cm)	58.8" (149.4 cm)	64.6" (164.1 cm)
3944301 3945001 3945021	27.7" (70.4 cm)	31.5" (80.0 cm)	31.5" (80.0 cm)	37.9" (96.3 cm)	10.0" (25.4 cm)	68.0" (172.7 cm)	73.9" (187.7 cm)

Nominal Width	Catalog Number	Electrical Requirements	Enclosure Height	Shipping Weight
Protector Demonstration Hoods				
3'	3944300	Not applicable	22.8" (57.9 cm)	75 lbs. (34 kg)
3'	3944301	Not applicable	32.0" (81.3 cm)	85 lbs. (39 kg)
Protector Demonstration Hood Systems – include Cart with Work Surface, Lower Transition Adapter and FilterMate Portable Exhauster				
3'	3945000*	115V, 60 Hz, 10 amps	22.8" (57.9 cm)	125 lbs. (57 kg)
3'	3945001*	115V, 60 Hz, 10 amps	32.0" (81.3 cm)	135 lbs. (61 kg)
3'	3945020*	230V, 50/60 Hz, 5 amps	22.8" (57.9 cm)	125 lbs. (57 kg)
3'	3945021*	230V, 50/60 Hz, 5 amps	32.0" (81.3 cm)	135 lbs. (61 kg)

*Filters are required but not included. See page 26 for ordering information.

FilterMate™ Portable Exhausters

Performance Features



FilterMate Portable Exhauster 3970003.

Includes HEPA filter.
Requires carbon filter (not included).



FilterMate Portable Exhauster 3970002.

Includes HEPA filter and thimble connection. Requires ducting to outside.

An accessory for the Protector XVS Ventilation Station, Protector Demonstration Hood and Protector Work Station, the FilterMate Portable Exhauster uses a HEPA filter, carbon filter or a combination of both to remove hazardous powders, particulates or vapors from the exhaust air stream and return filtered air to the environment.

All models feature:

- Compact, corrosion-resistant housing of powder-coated steel with rubber feet
- Variable-speed, non-sparking motorized impeller
- * Quiet operation. Oversized HEPA filter, efficient impeller and perforated exhaust cover work together to provide lower system exhaust velocity and noise pressure levels

Exhaust CFM	Noise Pressure dB(A)
100	45-47
150	51-54
200	56-61
250	63-65

- * Inherently safe design. A negative pressure plenum surrounds the positive pressure impeller so that if a leak occurs, the unfiltered air is captured and refiltered
- * Sized for Protector Demonstration Hoods, Protector XVS Ventilation Stations and Protector Work Stations. Capable of efficiently filtering up to 250 CFM for HEPA or carbon filtration; up to 200 CFM for combination HEPA/carbon filtration (60-100 fpm depending on enclosure model)
- Front-mounted rocker switch to control power to the blower.
- * Rear-mounted, auxiliary electrical outlet that may be connected to an airflow monitor or other user-supplied accessories
- * Only one FilterMate is required for all 2', 3' and 4' wide enclosures. Multiple FilterMates may be used for 5', 6' and 8' wide enclosures

- Included: 8 feet of 5" ID flexible gray polypropylene hose, two clamps and a 4.88" OD Upper Transition Adapter for connection to the top of the Protector XVS Ventilation Station, Protector Work Station or Protector Demonstration Hood. Models 3970004 and 3970024 include a 4.88" OD Lower Transition Adapter instead of the Upper Transition Adapter
- 6.5' IEC three-wire electrical cord with plug (115 volt models).
- 9' IEC three-wire electrical cord. An electrical plug is required (230 volt models)
- ETL listed (115 volt models)

All models conform to the following regulations and standards:

- UL* 61010-1
- CAN/CSA* C22.2 No. 61010-1
- CE*/UKCA Conformity Marking (230 volt models)

Models 3970000, 3970020, 3970002, 3970022, 3970003 and 3970023 feature:

- * HEPA filter, 99.99% efficient on particulates 0.3 micron in size
- True bag-in/bag-out filter disposal system for safely removing and replacing the filter without detaching the hose. The HEPA filter may be easily accessed by removing the exhaust cover for field leak testing by a certified technician

Models 3970002 and 3970022 feature:

- 6.06" ID thimble connection from the FilterMate to an existing house exhaust system for added safety

Models 3970001, 3970021, 3970003 and 3970023 require one each and Models 3970004 and 3970024 require two each (not included):

- Carbon Filter. Organic Vapor, Formaldehyde or Ammonia Filters are offered. See page 26

Optional Accessories

- Replacement HEPA Filter. See page 26
- Replacement Bag-In/Bag-Out Bag. See page 26
- Flexible Hose. See page 28
- Thimble Connection. See page 28

* Labconco exclusive feature

*See page 30 for a list of regulations, standards and registered trademarks.



FilterMate™ Portable Exhausters

Ordering Information & Dimensional Data

**Models 3970000, 3970001,
3970020 & 3970021**

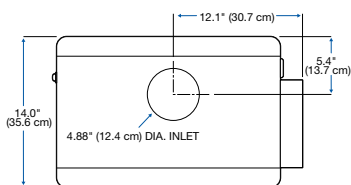

TOP

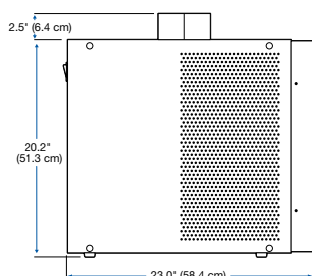

SIDE

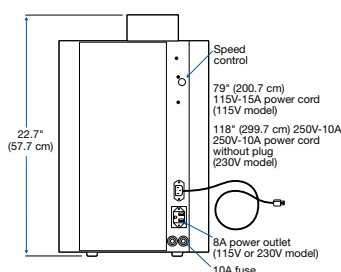

REAR

Models 3970002 & 3970021

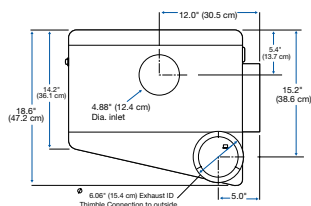

TOP

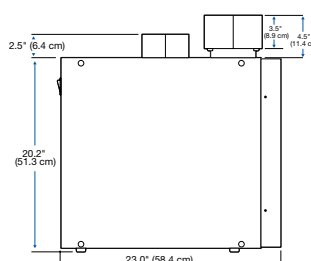

SIDE

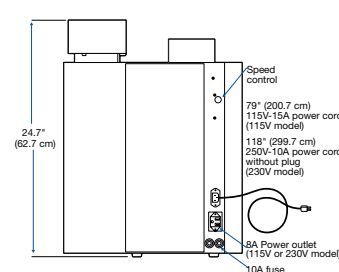

REAR

Models 3970003 & 3970023

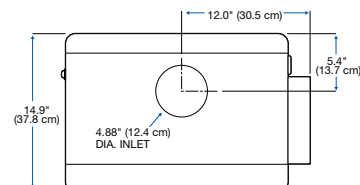

TOP

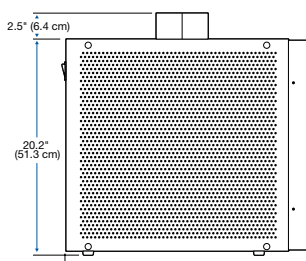

SIDE

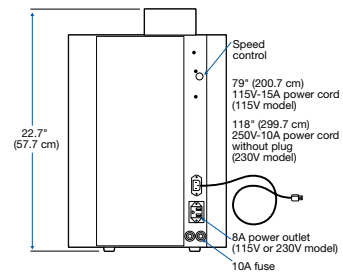

REAR

Catalog Number	Filter Usage	Overall Dimensions	Electrical Requirements	Airflow Potential	Exhaust Connection	Shipping Weight
3930000	HEPA included	14.0" w x 23.0" d x 22.7" h	115V, 60 Hz	250 CFM (60-100 fpm)	None. Room exhaust.	50 lbs.(23 kg)
3970020	HEPA included	14.0" w x 23.0" d x 22.7" h	230V, 50 Hz	250 CFM (60-100 fpm)	None. Room exhaust.	50 lbs. (23 kg)
3970001	Carbon required†	14.0" w x 23.0" d x 22.7" h	115V, 60 Hz	250 CFM (60-100 fpm)	None. Room exhaust.	48 lbs.(22 kg)
3970021*	Carbon required†	14.0" w x 23.0" d x 22.7" h	230V, 50 Hz	250 CFM (60-100 fpm)	None. Room exhaust.	48 lbs. (22 kg)
3970002	HEPA included	18.6" w x 23.0" d x 24.7" h	115V, 60 Hz	250 CFM (60-100 fpm)	6.06" ID Thimble to outside	54 lbs. (25 kg)
3970022*	HEPA included	18.6" w x 23.0" d x 24.7" h	230V, 50 Hz	250 CFM (60-100 fpm)	6.06" ID Thimble to outside	54 lbs. (25 kg)
3970003	HEPA included Carbon required†	14.9" w x 23.0" d x 22.7" h	115V, 60 Hz	200 CFM (60-100 fpm)**	None. Room exhaust.	54 lbs. (24 kg)
3970023*	HEPA included Carbon required††	14.9" w x 23.0" d x 22.7" h	230V, 50 Hz	200 CFM (60-100 fpm)**	None. Room exhaust.	54 lbs. (24 kg)
3970004	Two Carbon required††	14.9" w x 23.0" d x 22.7" h	115V, 60 Hz	200 CFM (60-100 fpm)**	None. Room exhaust.	54 lbs. (24 kg)
3970024	Two Carbon required†	14.9" w x 23.0" d x 22.7" h	230V, 50 Hz	200 CFM (60-100 fpm)**	None. Room exhaust.	54 lbs. (24 kg)

*International electrical configuration. †Carbon Filter is not included.
††HEPA filter may be removed and substituted with a second carbon filter.

**60-80 fpm on 4' enclosure.

FilterMate™ Portable Exhausters

Carbon and HEPA Filters

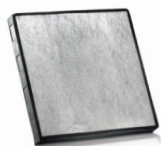

Carbon and HEPA Filters and Accessories for use with FilterMate Portable Exhausters

A HEPA Filter and Bag-In/Bag-Out Bag are included with FilterMate Portable Exhausters designed for use with HEPA filters. One or two Carbon Filters are required for operation with FilterMate Portable Exhausters designed for use with carbon filters.

Catalog Number	Description	Shipping Weight
3923400	Organic Carbon Filter, Type AC. Contains 12 pounds of granular activated carbon media.	14 lbs. (6.3 kg)
3923401	Formaldehyde Carbon Filter, Type ST-1. Contains a minimum of 14 pounds of impregnated carbon media.	17 lbs. (7.7 kg)
3923402	Ammonia Carbon Filter, Type AC. Contains a minimum of 16 pounds of impregnated carbon media.	21 lbs. (9.5 kg)
3707900	Replacement HEPA Filter, 99.99% efficient on particles 0.3 micron in size.	10 lbs. (4.5 kg)
3776002	Replacement Bag-In/Bag-Out Bag to ensure containment of particulate matter during HEPA filter changing.	1 lb. (0.5 kg)
1968800	Orange Cinching Strap for Bag-In/Bag-out Bag.	1 lb. (0.5 kg)
6925700	Ammonia Detector Tubes, package of 3.	0.5 lb. (0.2 kg)
6926000	Formaldehyde Detector Tubes, package of 3.	0.5 lb. (0.2 kg)
6924900	Syringe Kit for carbon filter saturation detection.	1 lb. (0.5 kg)

Labconco strongly recommends ordering and keeping an extra set of filters to have readily available when filters become saturated and require replacement.

Accessories

Solid Epoxy Work Surfaces

Black work surfaces are contoured to fit the dimensions of Protector XVS Ventilation Stations, Protector Demonstration Hoods and Protector Work Stations and dished to contain spills. One inch thick molded solid epoxy is chemical resistant and fire proof.

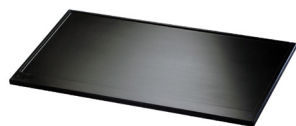

Catalog Number	Dimensions (w x d)	For use with:	Shipping Weight
3908400	24.0" x 26.7" (61.0 x 67.8 cm)	2' Protector XVS	48 lbs. (22 kg)
3908401	36.0" x 26.7" (91.4 x 67.8 cm)	3' Protector XVS, Protector Demonstration Hoods	72 lbs. (33 kg)
3908402	48.0" x 26.7" (121.9 x 67.8 cm)	4' Protector XVS, Protector Work Stations	96 lbs. (44 kg)
3908406	60.0" x 26.7" (152.4 x 67.8 cm)	5' Protector XVS - 29.0" deep models	120 lbs. (54 kg)
3908407	72.0" x 26.7" (182.9 x 67.8 cm)	6' Protector XVS - 29.0" deep models	144 lbs. (65 kg)
3908408	96.0" x 26.7" (243.8 x 67.8 cm)	8' Protector XVS - 29.0" deep models	192 lbs. (88 kg)
3908409	60.0" x 35.5" (152.4 x 90.2 cm)	5' Protector XVS - 35.5" deep models	160 lbs. (72 kg)
3908410	72.0" x 35.5" (182.9 x 90.2 cm)	6' Protector XVS - 35.5" deep models	192 lbs. (88 kg)
3908411	96.0" x 35.5" (243.8 x 90.2 cm)	8' Protector XVS - 35.5" deep models	255 lbs. (115 kg)

Stainless Steel Work Surfaces

Type 304 stainless steel work surfaces are 0.8" thick, have a one inch deep front spill trough and fit dimensions of the Protector XVS Ventilation Stations. Available in 5', 6' and 8' widths.



Catalog Number	Dimensions (w x d)	For use with:	Shipping Weight
3975500	60.0" x 26.7" (152.4 x 67.8 cm)	5' Protector XVS - 29.0" deep models	140 lbs. (64 kg)
3975501	60.0" x 35.5" (152.4 x 90.2 cm)	5' Protector XVS - 35.5" deep models	180 lbs. (82 kg)
3975600	72.0" x 26.7" (182.9 x 67.8 cm)	6' Protector XVS - 29.0" deep models	170 lbs. (77 kg)
3975601	72.0" x 35.5" (182.9 x 90.2 cm)	6' Protector XVS - 35.5" deep models	220 lbs. (100 kg)
3975800	96.0" x 26.7" (243.8 x 67.8 cm)	8' Protector XVS - 29.0" deep models	240 lbs. (109 kg)
3975801	96.0" x 35.5" (243.8 x 90.2 cm)	8' Protector XVS - 35.5" deep models	290 lbs. (132 kg)

Accessories



6942003—Work Surface with Sink. For use with Protector Work Stations. Accommodates standard dissecting boards. Molded black solid epoxy is chemical resistant and fire proof. Includes a 10.0" x 14.0" x 6.0" deep (25.4 x 35.6 x 15.2 cm) molded epoxy sink. Fixtures include a chrome-plated gooseneck faucet with vacuum breaker, two chrome-plated faucet controls and a spray nozzle with hose. **Sink requires a 1.5" diameter drain connection.** Dimensions: 48.0" w x 26.8" d x 1.25" thick (121.9 x 68.1 x 91.4 cm). Shipping weight 125 lbs. (57 kg)

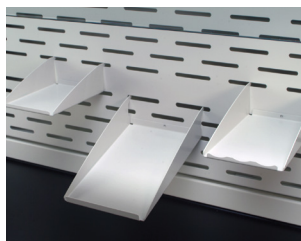

3925000—Utility Shelves. For use with Protector XVS Ventilation Stations and Protector Work Stations. Three shelves attach to the rear baffle perforations to hold items such as a balance printer, utensils and other miscellaneous supplies. Powder-coated steel. Shipping weight 5 lbs. (2 kg)



Fluorescent Task Lights. For use with Protector XVS Ventilation Stations and Protector Demonstration Hoods. To be placed atop the enclosure to enhance illumination of the interior. Include auxiliary electrical receptacle with switch for connection of accessories such as a printer or airflow monitor.

Catalog Number	Description	Shipping Weight
3909200	115V, 60 Hz, 10 amps. Includes IEC, three-wire cord with plug.	15 lbs. (7 kg)
3909201*	230V, 50 Hz, 10 amps. Includes IEC, three-wire cord. Plug is required (not included).	15 lbs. (7 kg)

*International electrical configuration.



8026000—Cart for Protector Demonstration Hoods. Provides mobile support for Protector Demonstration Hoods and 3' Protector XVS Ventilation Stations. Glacier white powder-coated tubular steel with black 1" thick solid epoxy dished work surface, handlebar, bottom shelf and 4" diameter toe-locking casters. Supports loads up to 400 pounds. Dimensions: 39.0" w x 31.9" d x 36.0" h (99.1 x 81.0 x 91.4 cm). Shipping weight 50 lbs. (23 kg)



3927700—Bottle Holder. For use with Protector XVS Ventilation Stations and Protector Work Stations. Attaches to the rear baffle perforations to hold a squirt bottle or other round container. Powder-coated steel. 3" diameter opening. Shipping weight 1 lb. (0.5 kg)



3927800—Tissue Holder. For use with Protector XVS Ventilation Stations and Protector Work Stations. Attaches to the rear baffle perforations to hold tissue wipers in the upside down position. An opening in the bottom of the holder permits wipers to be dispensed from the bottom. Powder-coated steel. Shipping weight 1 lb. (0.5 kg)

Accessories



5248300—Waste Chute Stopper. For use with 5', 6' and 8' Protector XVS Ventilation Stations, 35.5" deep with waste chute. When waste chute is not in use, the stopper helps prevent contaminants from escaping from the enclosure through the side wall. Solid rubber. 5" diameter. Shipping weight 1 lb. (0.5 kg)

Flexible Hoses for FilterMate™ Portable Exhauster. For use with the FilterMate Portable Exhauster instead of the flexible polypropylene hose included. 8' length. Include two clamps.

Catalog Number	Description	Shipping Weight
3927500	5" ID, clear urethane, smooth bore with white helix, static dissipative, suitable for pharmaceutical and clean room applications.	3 lbs. (1 kg)
3927600	6" ID, black thermoplastic rubber hose with 6.09" ID cuffs, suitable for pharmaceutical and clean room applications. May be used to duct to the outside. Requires 3927400 Adapter, 5" Round to 6" Round, sold separately.	3 lbs. (1 kg)



3913600—Thimble Connection Kit. For retrofitting FilterMate Portable Exhausters 3970000, 3970020, 3970001, 3970004 and 3970024. Included with FilterMate Portable Exhausters 3970002 and 3970022. Shipping weight 10 lbs. (4 kg)

Guardian™ 1000 Digital Airflow Monitors Mount atop Protector XVS Ventilation Stations, Protector Demonstration Hoods and Protector Work Stations in factory-prepared location. Monitor and alert the operator to low airflow conditions. Include face plate with circuit board, electrical power pack, airflow hose, flow hose adapter and glacier white powder-coated steel casing. LCD displays actual airflow in fpm or m/s from 0 to 999 fpm (0 to 5.0 m/s). Audible/visual alarm alerts user to sustained low velocity condition. Calibration instructions displayed on LCD. LED lights display red for alarm, yellow for caution, green for normal. Include temperature-compensated sensor, external alarm, RS-232 port, night setback and alarm mute functions. UL and CE listed**.

Catalog Number	Electrical Requirements	Shipping Weight
3908800	115V, 60 Hz	10 lbs. (4.5 kg)
3908801*	230V, 50 Hz	10 lbs. (4.5 kg)



Guardian™ 500 Airflow Monitors Mount atop Protector XVS Ventilation Stations, Protector Demonstration Hoods and Protector Work Stations in factory-prepared location. Include face plate with circuit board, electrical power pack, tubing, airflow tube adapter and glacier white powder-coated steel casing. From the monitor's face plate, the user can easily select and calibrate a setpoint between 30 and 250 fpm using a velocity meter and a screwdriver. A green LED glows to indicate "safe" when airflow is greater than the low setpoint. A red LED flashes to indicate "low" when airflow is below the low setpoint. An amber LED flashes when the sash is raised above the maximum safe working opening. An audible alarm sounds (and can be muted) when under "low" and "sash high" conditions. Include night setback, external alarm and alarm mute functions.

Catalog Number	Electrical Requirements	Shipping Weight
3944700	115V, 60 Hz	10 lbs. (4.5 kg)
3944701*	230V, 50 Hz	10 lbs. (4.5 kg)

*International electrical configuration.

**See page 30 for a list of regulations, standards and registered trademarks.

Accessories



Remote Blowers. A remote blower is required when ducting the Protector XVS Ventilation Station, Protector Demonstration Hood or Protector Work Station to the outside. The direct drive blower has a 1/4 hp TEFC-type motor. Housing and impeller are corrosion-resistant, phenolic-coated steel. Blower inlet is 5.94" OD and is sized to accept 6" nominal diameter PVC duct. Blower outlet is 4.25" x 7.38" OD (10.8 x 18.7 cm). Dimensions: 14.6" w x 13.5" d x 13.25" high (37.1 x 34.3 x 33.7 cm).

Catalog Number	Electrical Requirements	Shipping Weight
4863500	115V, 60 Hz, 4.4 amps	35 lbs. (16 kg)
4863501*	115/230V, 50 Hz, 5.6/2.8 amps	35 lbs. (16 kg)
7053501**	115V, 60 Hz 4.4 amps	40 lbs. (18 kg)

* International electrical configuration. ** Explosion-proof

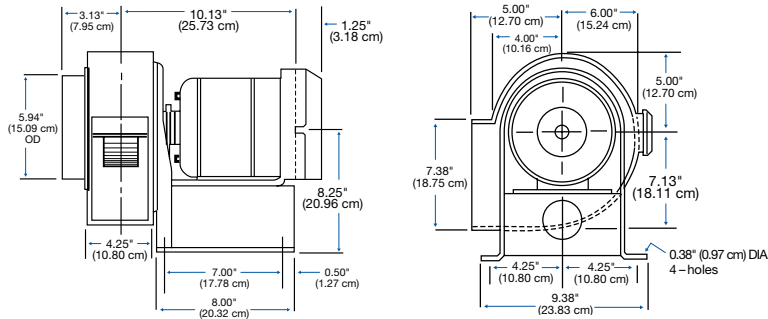

CFM @ Static Pressure –Inches of H ₂ O						
S.P.	0.0"	0.13"	0.25"	0.50"	0.75"	0.87"
CFM	595	560	515	420	300	167

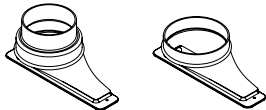

3912400

3912401

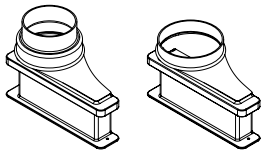

3912402

3912403

Exhaust Transition Adapters For use with Protector XVS Ventilation Stations, Protector Demonstration Hoods and Protector Work Stations designed for outside ducting or connected to the FilterMate Portable Exhauster. Chemical resistant, one-piece molded polyethylene.

Catalog Number	Electrical Requirements	Shipping Weight
3912400	Upper Exhaust Transition Adapter, 2" x 10" rectangular to 5" diameter round for connection to 5" ID hose (included with FilterMate Portable Exhauster)	5 lbs. (2 kg)
3912401	Upper Exhaust Transition Adapter, 2" x 10" rectangular to 6" diameter round for connection to 6" OD duct	5 lbs. (2 kg)
3912402	Lower Exhaust Transition Adapter, 2" x 10" rectangular to 5" diameter round for connection to 5" ID hose	5 lbs. (2 kg)
3912403	Lower Exhaust Transition Adapter, 2" x 10" rectangular to 6" diameter round for connection to 6" OD duct	5 lbs. (2 kg)

Ductwork

Catalog Number	Description	Equivalent Resistance [†]	Shipping Weight
4708600	Thermoplastic Duct, 6.625" OD, 6.250" ID, 10' length	10'	25 lbs. (11 kg)
4708900	Female PVC Duct Coupling, 6" nominal diameter, connects two sections of Thermoplastic Duct	0'	4 lbs. (2 kg)
4708700	90° PVC Elbow, 6" nominal diameter, has belled end connections to directly receive Thermoplastic Duct or Male Duct Coupling	12'	1 lb. (0.5 kg)
3924000	Manual Exhaust Damper, powder-coated steel, 6" nominal diameter	1'	1 lb. (0.5 kg)
4724200	Manual Exhaust Damper, PVC, 6" nominal diameter	1'	1 lb. (0.5 kg)
4861800	Flexible Duct Connection, 7" nominal diameter, for use with 6" nominal diameter duct	1'	8 lbs. (4 kg)
4861700	Blower Transition Adapter, 4.25" x 7.75" rectangle to 6" diameter round	1'	3 lbs. (1 kg)
4722200	Zero Pressure Weathercap, 6" nominal diameter, fits atop Thermoplastic Duct	5'	20 lbs. (9 kg)

[†]Equivalent resistance is measured in feet of straight duct.

Standards & Registered Trademarks

Standards

Key aspects of standards and codes as they relate to ductless enclosures are summarized below.

ASHRAE 110 Method of Testing Performance of Laboratory Fume Hoods (ANSI Approved)

Evaluates fume hood's containment characteristics.

- Three part test: Smoke generation, face velocity profile, tracer gas release at 4 liters per minute
- Rated As Manufactured (AM), As Installed (AI) and As Used (AU)

Labconco comment: For Paramount Ductless Enclosures and Protector Work Stations, the ASHRAE test is modified to accommodate the enclosures' fixed sash heights.

American Society of Heating, Refrigerating and Air-Conditioning Engineers

1791 Tullie Circle NE
Atlanta, GA 30329
(404) 636-8400 www.ashrae.org

ANSI Z9.5 Standard—Laboratory Ventilation

Covers entire laboratory ventilation system.

- New and remodeled hoods shall have a monitoring device
- Hazard evaluation and analysis required

American Industrial Hygiene Association

2700 Prosperity Avenue, Suite 250
Fairfax, VA 22031
(703) 849-8888 www.aiha.org

American Society of Safety Professionals

520 N. Northwest Highway
Park Ridge, IL 60068
(847) 699-2929 www.assp.org

CAN/CSA Standard C22.2 No. 61010-1 Safety Requirements for Electrical Equipment for Measurement, Control and Laboratory Use

Specifies general safety requirements for electrical equipment.

- Design and methods of construction should provide adequate protection to the operator and the surrounding area against shock or burn, mechanical hazards, excessive temperature, spread of fire from the equipment, gas liberation, explosion or implosion

Canadian Standards Association

5060 Spectrum Way, Suite 100
Mississauga, Ontario
L4W 5N6
CANADA
(800) 463-6727 or (416) 747-4044
www.csa.ca

CE Marking

Indicates an electrical apparatus conforms to all safety and other directives/specifications presently required by the Council of European Communities.

- Electrical safety
- Electromagnetic emissions testing — interference signals being output by the product
- Electromagnetic immunity testing — the product does not respond to outside electromagnetic interference signals

European Union

www.europa.eu

Registered Trademarks

AutoCAD® is a registered trademark of Autodesk, San Rafael, California.

ANSI® is a registered trademark of American National Standards Institute.

SafeBridge® is a registered trademark of SafeBridge Consultants, Inc., Mountain View, California.

SEFA® is a registered trademark of Scientific Equipment and Furniture Association.

UL® is a registered trademark of UL, LLC.

ETL listing

ETL (formerly Edison Testing Laboratories) is a Nationally Recognized Testing Laboratory.

(NRTL). The ETL mark signifies that a product conforms to the following:

- UL Standard 3101-1 in the U.S.
- CAN/CSA Standard C22.2 No. 1010.1 in Canada

Products that bear the ETL mark are subjected to a comprehensive safety program that includes testing, listing, labeling and quarterly follow-up inspections.

Intertek Group

www.intertek.com

Standards & Registered Trademarks

SEFA 1 Laboratory Fume Hoods Recommended Practices

- Fume hood face velocities based on toxicity levels of chemicals
- Test method — face velocity profile and smoke generation

SEFA 8 Recommended Practices For Metal Laboratory Grade Furniture, Case-work, Shelving and Tables, 8.0 Cabinet Surface Finish Tests

- Laboratory grade paint finishes shall withstand chemical exposure, hot water, and impact from a one-pound ball dropped from 12"
- Paint coating shall sufficiently adhere to the substrate
- Paint shall be resistant to scratches

SEFA 9 Recommended Practices for Ductless Enclosures

- Ductless hoods do not have the same scope of application as standard fume hoods, biological safety cabinet or potent compound hoods
- Ductless filtration categories are defined as:
 - DH I — Has a filtration device to control non-toxic chemicals, nuisance odors, particulates
 - DH II — Meets DH I requirements plus equipped with a filtration device to filter manufacturer approved toxic contaminants up to filter break through only
 - DH III — Meets DH I and II requirements plus equipped with a filtration device to filter manufacturer approved toxic contaminants beyond primary breakthrough by providing secondary back-up protection
- Prior to approving usage, the manufacture should review all applications and determine the compatibility or incompatibility of the ductless hood
- DH II/III hoods require constant monitoring of filter saturation breakthrough and should have a continuous audible and visual automatic saturation detection monitoring device. The device on DH II hoods should detect breakthrough so that measurements taken downstream from the filter does not exceed 50% of the TLV of the contaminant(s). The device on DH III hoods should detect breakthrough so that measurements taken downstream from the filter does not exceed 1% of the TLV of the contaminant(s)
- DH II/III hoods should have a permanent face velocity monitoring device

Scientific Equipment & Furniture Association

1205 Franklin Avenue
Suite 320
Garden City, NY 11530
(516) 294-5424
www.sefalabs.com

UL 61010-1 Electrical Equipment for Laboratory Use

Specifies the general safety requirements for electrical equipment.

- Based on International Electrotechnical Commission (IEC) Publication 61010-1 with differences noted for U.S. use
- Protection against electrical shock, mechanical hazards, spread of fire, radiation, liberated gases, explosion and implosion
- Resistance to shock, vibration, impact, heat, moisture and liquids

Underwriters Laboratories Inc.

333 Pfingsten Road
Northbrook, IL 60062-2096
(847) 272-8800
www.ul.com

**Visit labconco.com to request information
for all Labconco products.**

LABCONCO CORPORATION

8811 Prospect Avenue
Kansas City, MO 64132

(800) 821-5525 | (816) 333-8811

labconco.com



©2023 LABCONCO CORPORATION

Printed in the U.S.A.

Product design subject to change without notice.

3-04-6/05/23

